

FOR LEASE

Howard County, Maryland

7531 MONTPELIER ROAD

LAUREL, MARYLAND 20723

AVAILABLE

5,443 sf

YEAR BUILT

2015

ZONING

PEC (Planned Employment Center)

TRAFFIC COUNT

17,954 AADT (Johns Hopkins Rd)

RENTAL RATE

\$34.00 psf

HIGHLIGHTS

- ▶ Newly constructed restaurant space off of Columbia Pike / Rt. 29 - 88,842 cars per day
- ▶ Adjacent to brand new Homewood Suites Hotel on Montpelier Road
- ▶ Owner has a 7-day full Liquor License for the property



Sean Langford | Vice President

443.573.3218

slangford@mackenziecommercial.com

MacKenzie Commercial Real Estate Services, LLC • 410-821-8585 • 2328 W. Joppa Road, Suite 200 | Lutherville-Timonium, Maryland 21093 • www.MACKENZIECOMMERCIAL.com

FOR LEASE

Howard County, Maryland

FLOOR PLAN

7531 MONTEPELIER ROAD | LAUREL, MARYLAND 20723

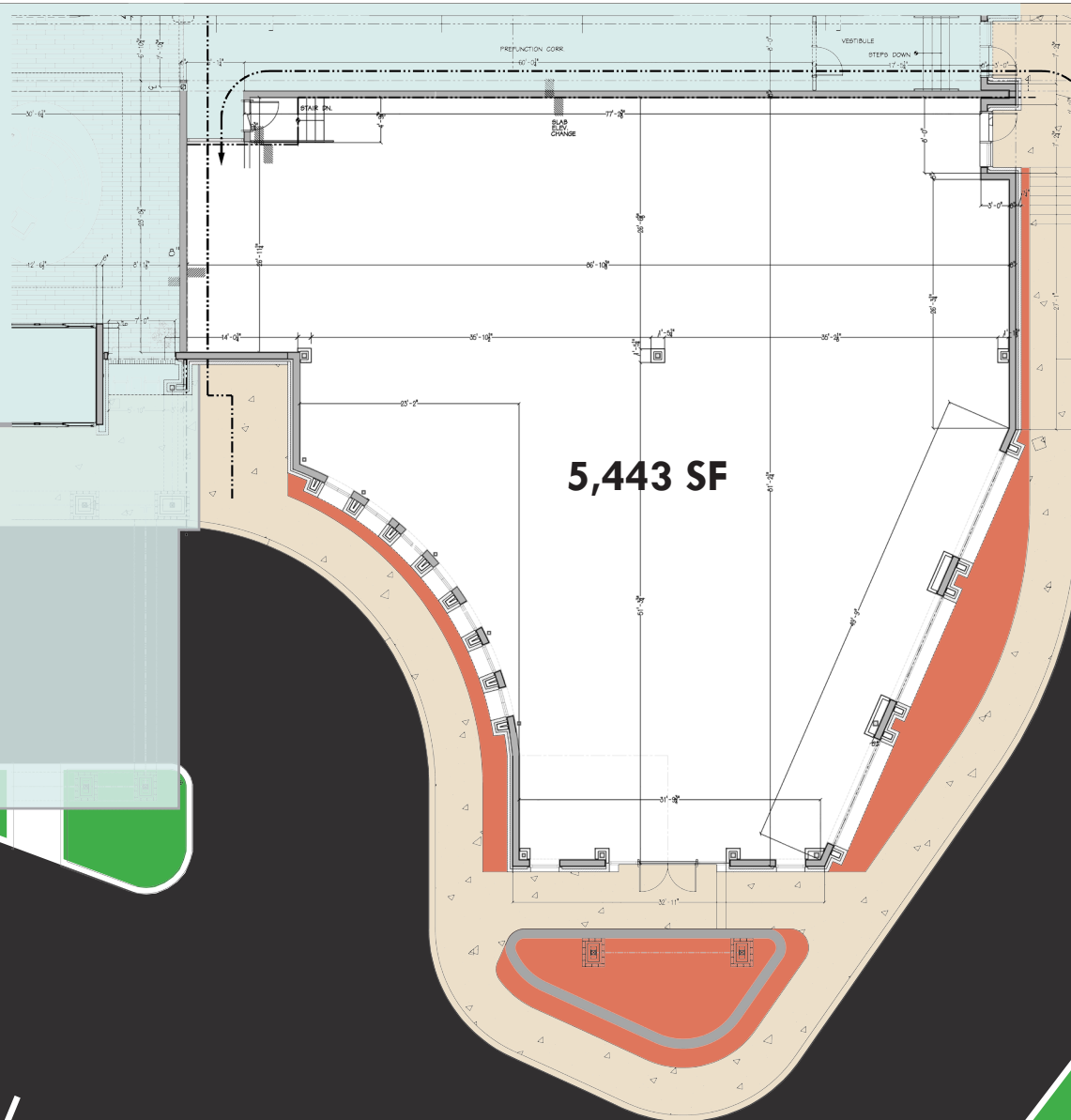

5,443 SF



Sean Langford | Vice President

☎ 443.573.3218

✉ slangford@mackenziecommercial.com

MacKenzie Commercial Real Estate Services, LLC • 410-821-8585 • 2328 W. Joppa Road, Suite 200 | Lutherville-Timonium, Maryland 21103 • www.MACKENZIECOMMERCIAL.com

FOR LEASE

Howard County, Maryland

AERIAL

7531 MONTEPELIER ROAD | LAUREL, MARYLAND 20723



FOR LEASE

Howard County, Maryland

LOCAL TRADE AREA

7531 MONTPELIER ROAD | LAUREL, MARYLAND 20723

7531 MONTPELIER ROAD enjoys close proximity to **Maple Lawn**, an award-winning, 600+ acre, mixed-use development, which currently includes 1,200,000 sf of Class A office/medical space, 120,000 sf of retail space, 210,000 sf of flex space and approximately 1,250 high-end residences.



FOR LEASE

Howard County, Maryland

REGIONAL TRADE AREA

7531 MONTPELIER ROAD | LAUREL, MARYLAND 20723

DOMINANT LIFESTYLES

2 mile radius



33% Top Tier



LEARN MORE

esri.com/tapestry

Average HH Size: 2.82
Median Age: 46.2
Median HH Income: \$157,000

25% Enterprising Professionals



LEARN MORE

esri.com/tapestry

Average HH Size: 2.46
Median Age: 34.8
Median HH Income: \$77,000

21% Professional Pride



LEARN MORE

esri.com/tapestry

Average HH Size: 3.11
Median Age: 40.5
Median HH Income: \$127,000



FOR LEASE

Howard County, Maryland

LOCATION / DEMOGRAPHICS

7531 MONTEPELIER ROAD | LAUREL, MARYLAND 20723

DEMOGRAPHICS

1 mile 3 miles 5 miles



Population

5,294 44,235 166,035



Number of Households

1,652 15,412 61,741



Average Household Income

\$203,176 \$170,496 \$126,919



Daytime Employees

10,764 37,472 116,588

RETAIL EXPENDITURES

1 mile 3 miles 5 miles



Furniture & Home

\$4.6M \$36.8M \$110.5M



Entertainment & Recreation

\$12.1M \$96.4M \$290.0M



Fashion & Clothing

\$8.3M \$66.5M \$204.4M



Food & Drink

\$12.3M \$100.6M \$310.2M

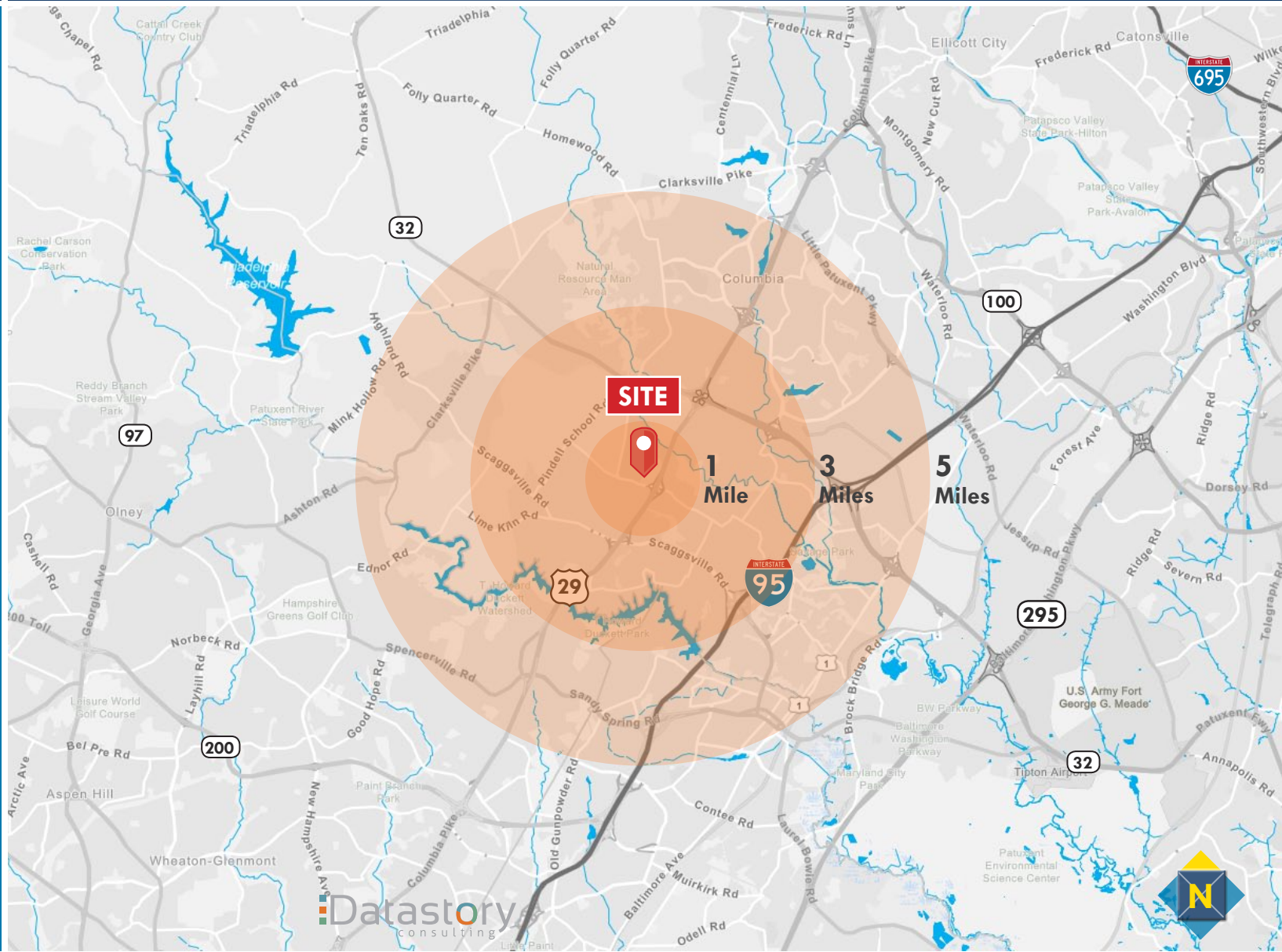

Sean Langford | Vice President

443.573.3218

slangford@mackenziecommercial.com

No warranty or representation, expressed or implied, is made as to the accuracy of the information contained herein, and same is submitted subject to errors, omissions, change of price, rental or other conditions, withdrawal without notice, and to any specific listing conditions imposed by our principals.