

FOR SALE

Talbot County, Maryland

MEDICAL OFFICE BUILDING

555 CYNWOOD DRIVE | EASTON, MARYLAND 21601

BUILDING SIZE

5,060 sf

SITE SIZE

36,590 sf / .84 acres

ZONING

HC - Healthcare

YEAR BUILT

2000

PARKING RATIO

7 : 1,000 sf

SALE PRICE

\$1,250,000

HIGHLIGHTS

- ▶ 100% leased with a general practitioner practice associated with Anne Arundel Medical Center - lease expires 12/31/2023
- ▶ Medical office building conveniently located in the medical market of Easton
- ▶ 4 doctor offices and 11 exam rooms



FOR SALE



Talbot County, Maryland

FLOOR PLAN

555 CYNWOOD DRIVE | EASTON, MARYLAND 21601

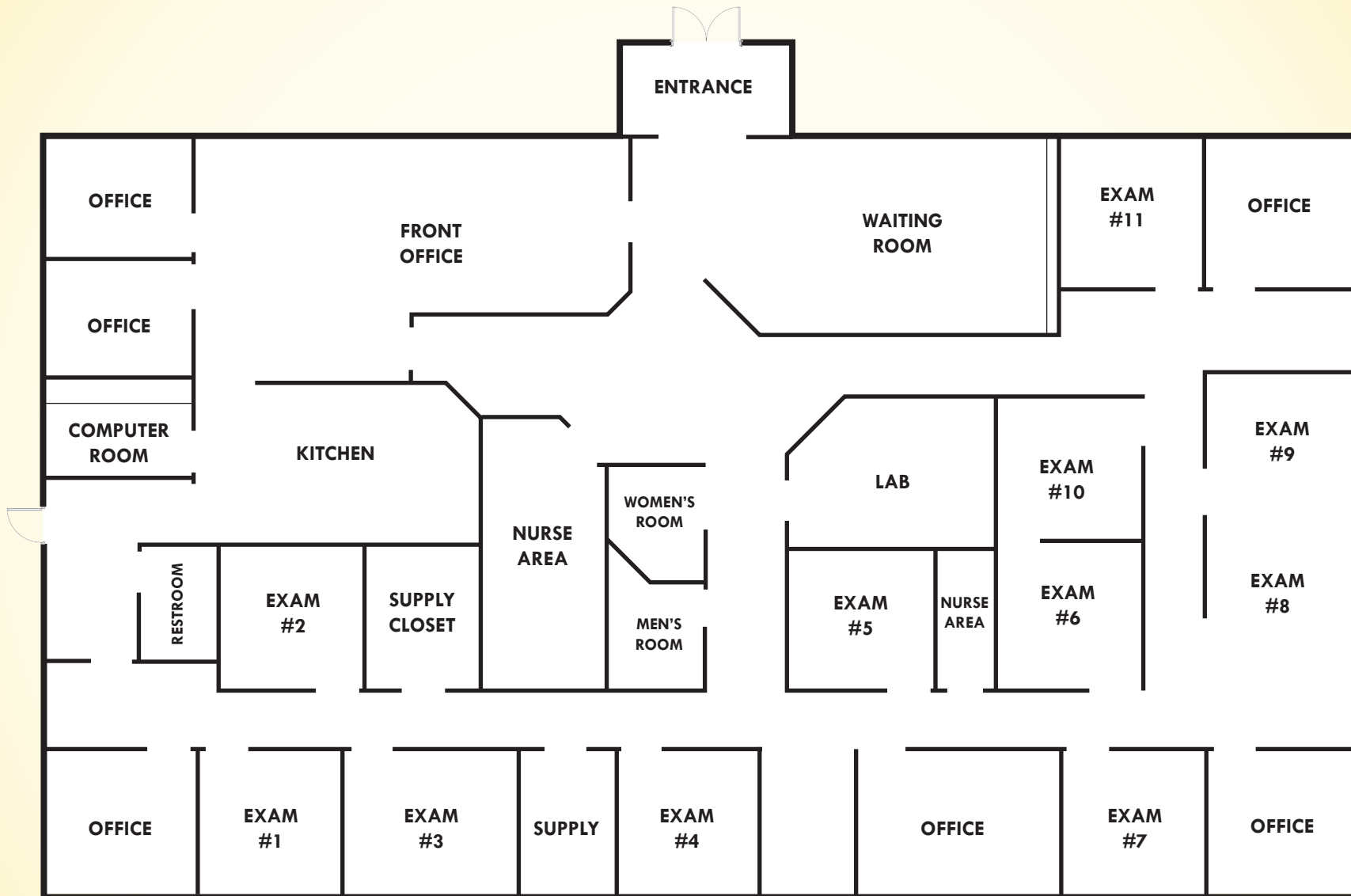

FOR SALE

Talbot County, Maryland

LOCATION

555 CYNWOOD DRIVE | EASTON, MARYLAND 21601

