

FOR LEASE

 Harford County, Maryland



INDUSTRIAL WAREHOUSE WITH OUTSIDE STORAGE

ABERDEEN BUSINESS CENTER

1232 S. PHILADELPHIA BLVD, BLDG. B
ABERDEEN, MARYLAND 21001

VIRTUAL TOUR



Andrew Meeder, SIOR | Senior Vice President & Principal
☎ 410.494.4881 ✉ ameeder@mackenziecommercial.com

MacKenzie Commercial Real Estate Services, LLC • 443-573-3200 • 111 S. Calvert Street, Suite 2800 | Baltimore, Maryland 21202 • www.MACKENZIECOMMERCIAL.com

Tom Mottley | Senior Vice President & Principal
☎ 443.573.3217 ✉ tmottley@mackenziecommercial.com

FOR LEASE

Harford County, Maryland

INDUSTRIAL WAREHOUSE W/ OUTSIDE STORAGE

ABERDEEN BUSINESS CENTER | 1232 S. PHILADELPHIA BOULEVARD, BLDG. B | ABERDEEN, MARYLAND 21001

AVAILABLE

3,750-7,500 sf ±
(includes 350 sf ± of office space)

ZONING

M-1 (Light Industrial)

LOADING

1 Dock

HIGHLIGHTS

- ▶ 7,500 sf ± freestanding building (divisible down to 3,750 sf ±)
- ▶ Ample on-site parking
- ▶ 16' ceilings
- ▶ Outside storage potential (rear parking field)
- ▶ Ingress/egress from both Loflin Rd and S. Philadelphia Blvd
- ▶ Route 40 frontage (easy to find)
- ▶ Easy access to major roads

[CLICK FOR VIRTUAL TOUR](#)



STREET VIEW



PYLON



DOCK



REAR PARKING FIELD

FOR LEASE

Harford County, Maryland

AERIAL

ABERDEEN BUSINESS CENTER | 1232 S. PHILADELPHIA BOULEVARD, BLDG. B | ABERDEEN, MARYLAND 21001



FOR LEASE

Harford County, Maryland

FLOOR PLAN

ABERDEEN BUSINESS CENTER | 1232 S. PHILADELPHIA BOULEVARD, BLDG. B | ABERDEEN, MARYLAND 21001

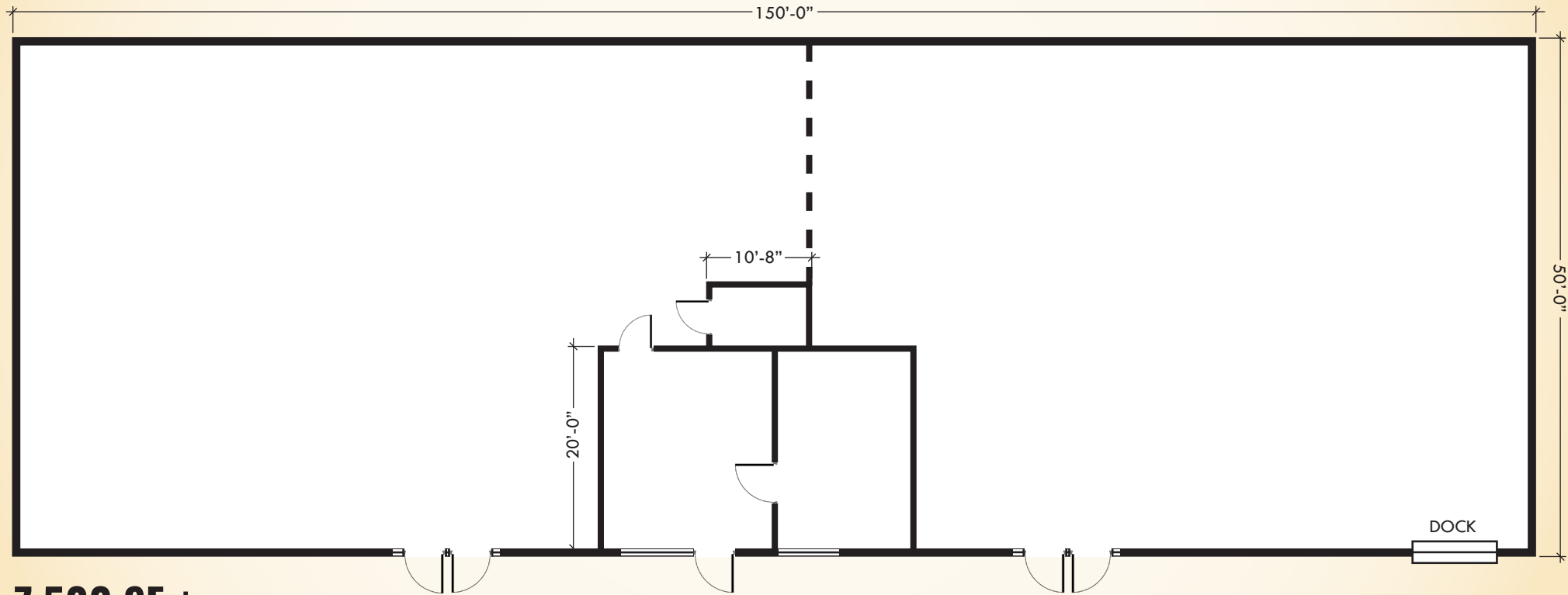

7,500 SF ±
(DIVISIBLE)

FOR LEASE



Harford County, Maryland

INTERIOR PHOTOS

ABERDEEN BUSINESS CENTER | 1232 S. PHILADELPHIA BOULEVARD, BLDG. B | ABERDEEN, MARYLAND 21001

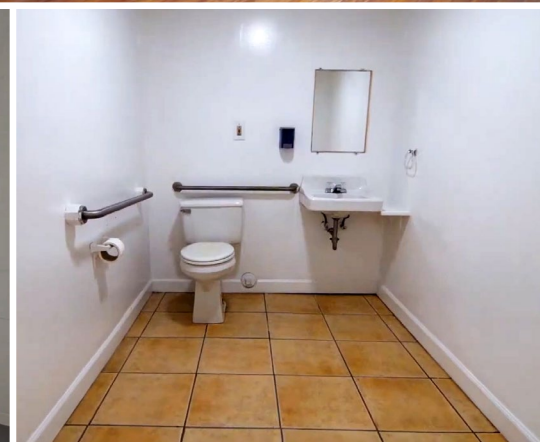

 **MACKENZIE**
COMMERCIAL REAL ESTATE SERVICES, LLC

Andrew Meeder, SIOR | Senior Vice President & Principal
☎ 410.494.4881 ✉ ameeder@mackenziecommercial.com

MacKenzie Commercial Real Estate Services, LLC • 443-573-3200 • 111 S. Calvert Street, Suite 2800 | Baltimore, Maryland 21202 • www.MACKENZIECOMMERCIAL.com

Tom Mottley | Senior Vice President & Principal
☎ 443.573.3217 ✉ tmottley@mackenziecommercial.com

FOR LEASE

Harford County, Maryland

TRADE AREA

ABERDEEN BUSINESS CENTER | 1232 S. PHILADELPHIA BOULEVARD, BLDG. B | ABERDEEN, MARYLAND 21001



FOR LEASE

Harford County, Maryland

LOCATION

ABERDEEN BUSINESS CENTER | 1232 S. PHILADELPHIA BOULEVARD, BLDG. B | ABERDEEN, MARYLAND 21001

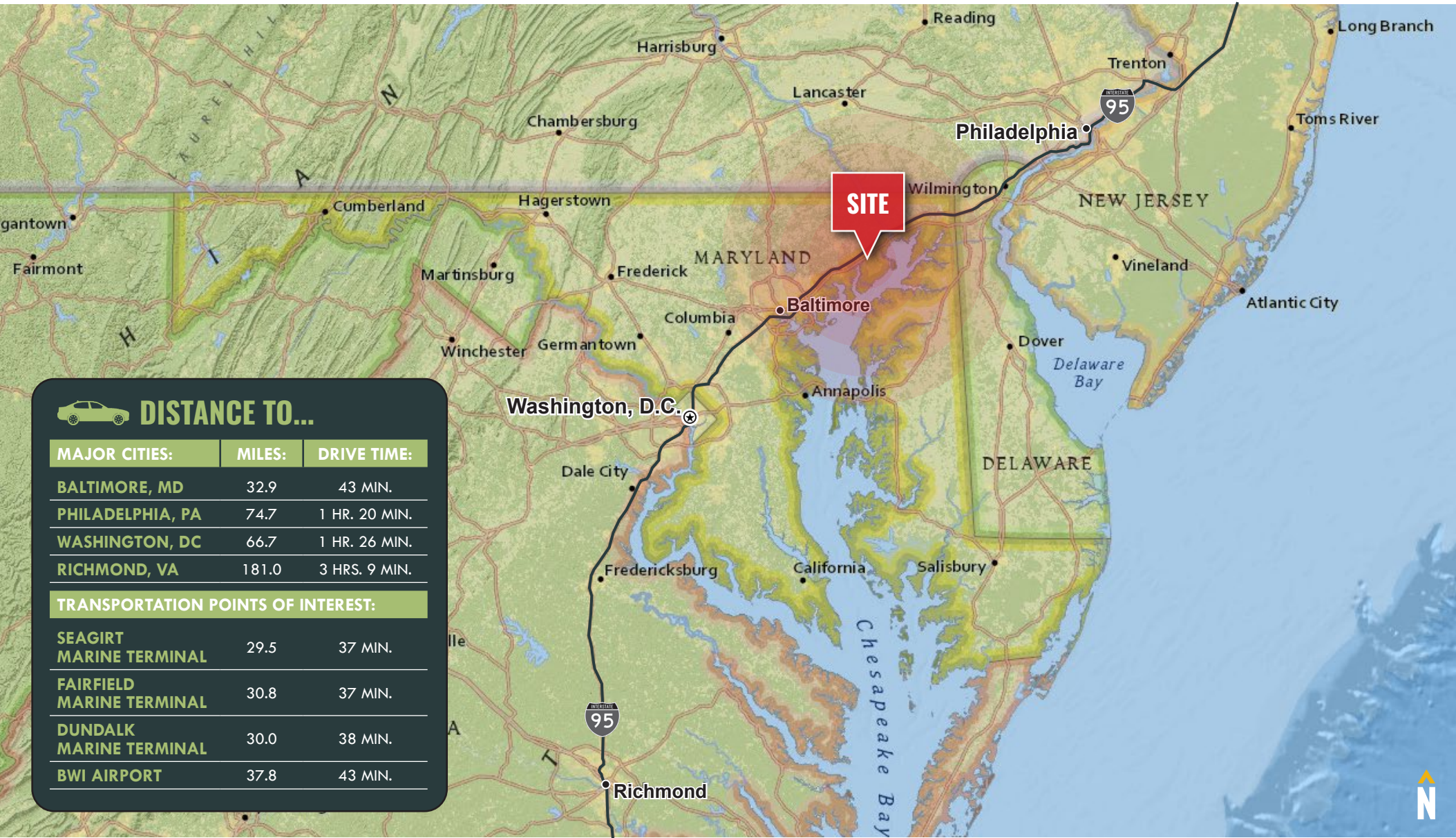

DISTANCE TO...

MAJOR CITIES:	MILES:	DRIVE TIME:
BALTIMORE, MD	32.9	43 MIN.
PHILADELPHIA, PA	74.7	1 HR. 20 MIN.
WASHINGTON, DC	66.7	1 HR. 26 MIN.
RICHMOND, VA	181.0	3 HRS. 9 MIN.

TRANSPORTATION POINTS OF INTEREST:	MILES:	DRIVE TIME:
SEAGIRT MARINE TERMINAL	29.5	37 MIN.
FAIRFIELD MARINE TERMINAL	30.8	37 MIN.
DUNDALK MARINE TERMINAL	30.0	38 MIN.
BWI AIRPORT	37.8	43 MIN.



ANDREW MEEDER, SIOR

SENIOR VICE PRESIDENT & PRINCIPAL
MACKENZIE COMMERCIAL REAL ESTATE SERVICES, LLC

410.494.4881

AMEEDER@MACKENZIECOMMERCIAL.COM



TOM MOTTLEY

SENIOR VICE PRESIDENT & PRINCIPAL
MACKENZIE COMMERCIAL REAL ESTATE SERVICES, LLC

443.573.3217

TMOTTLEY@MACKENZIECOMMERCIAL.COM

MacKenzie Commercial Real Estate Services, LLC • 410-821-8585 • 111 S. Calvert Street | Baltimore, Maryland 21202 • www.MACKENZIECOMMERCIAL.com

No warranty or representation, expressed or implied, is made as to the accuracy of the information contained herein, and same is submitted subject to errors, omissions, change of price, rental or other conditions, withdrawal without notice, and to any specific listing conditions imposed by our principals.

