

# 2003 COMMERCE PARK DRIVE

## FLEX/WAREHOUSE

THE  
RMR  
GROUP

### Available

- » 3,567 - 14,401 RSF

### Zoning

- » W1 (Industrial Park District) - Sample Uses Include:

Adult Day Care	Offices
Catering Establishments	Religious Facilities
Non-profit/Charities	Health Clubs
Laboratories/R&D	Organizations
Computer Sale/Service	Personal Fitness
Showrooms	Schools/Training Facility

### Occupancy

- » Immediate

### Building Features

- » Clear ceiling height: 16' - 18'
- » Drive-in dock doors: 12' x 12'
- » 2.49/1,000 sf parking ratio
- » Office + flex buildouts

### Unparalleled Annapolis Location

- » Accessible from Route 50, MD 665, and I-97



**MACKENZIE**

COMMERCIAL REAL ESTATE SERVICES, LLC





# 2003 COMMERCE PARK DRIVE PHOTOS

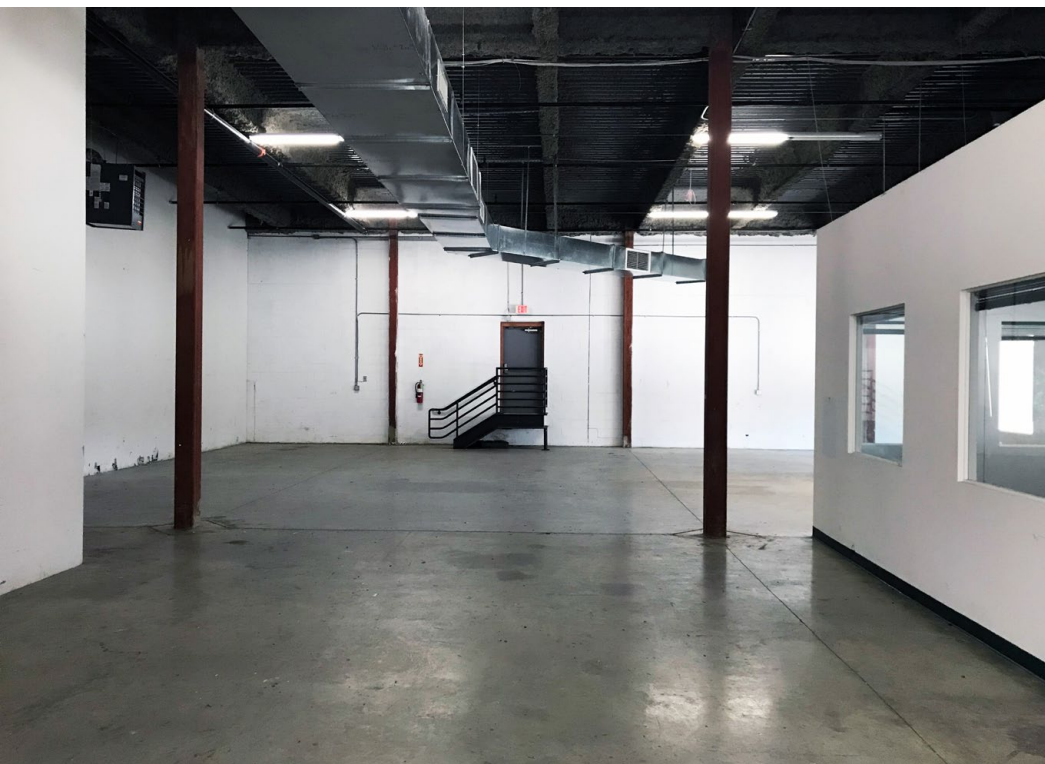



# NEARBY AMENITIES

**Westfield Annapolis Mall**

★ macy's JCPenney H&M  
Apple Store Crate&Barrel LOFT  
Under Armour The Cheesecake Factory BOW-TIE CINEMAS californ PIZZA KITCHEN  
Red Robin MAGGIANO'S Nando's

**COMMERCE PARK DRIVE**

**Annapolis Plaza**

TRADER JOE'S  
Marshalls JOANN  
HomeGoods Reico  
HOMESENSE

**Gateway Plaza**

SAFeway BEST BUY  
Staples PETSMART DICK'S  
OrangeTheory

Sam's Club

THE HOME DEPOT

**Festival at Riva**

Giant petco Michaels TJ-maxx  
CHUCK E. CHEESE'S BUFFALO WILD WINGS  
five BELOW

**Annapolis Towne Centre**

TARGET 24 FITNESS  
WHOLE FOODS Coldwater Creek  
BED BATH & BEYOND P.F. CHANG'S  
Bassett Gordon Biersch Qdoba

LIDL  
KOHL'S

**Forest Plaza**

THE HOME DEPOT  
OUTBACK STEAKHOUSE  
DOLLAR TREE

SAFeway

**Annapolis Harbour Center**

THE FRESH MARKET BARNES & NOBLE DSW Starbucks  
OLD NAVY NORDSTROM rack ULTA  
FRIDAYS POTBELLY BOW-TIE CINEMAS

SEVERN RIVER

sjc St. John's College  
USN UNITED STATES NAVAL AC

**Bay Ridge Market Place**

Tuesday Morning  
West Marine  
DOLLAR GENERAL  
ANNAPOLIS  
SMOKEHOUSE & TAVERN

SOUTH RIVER



# FLOOR PLANS

## 2003 COMMERCE PARK DRIVE

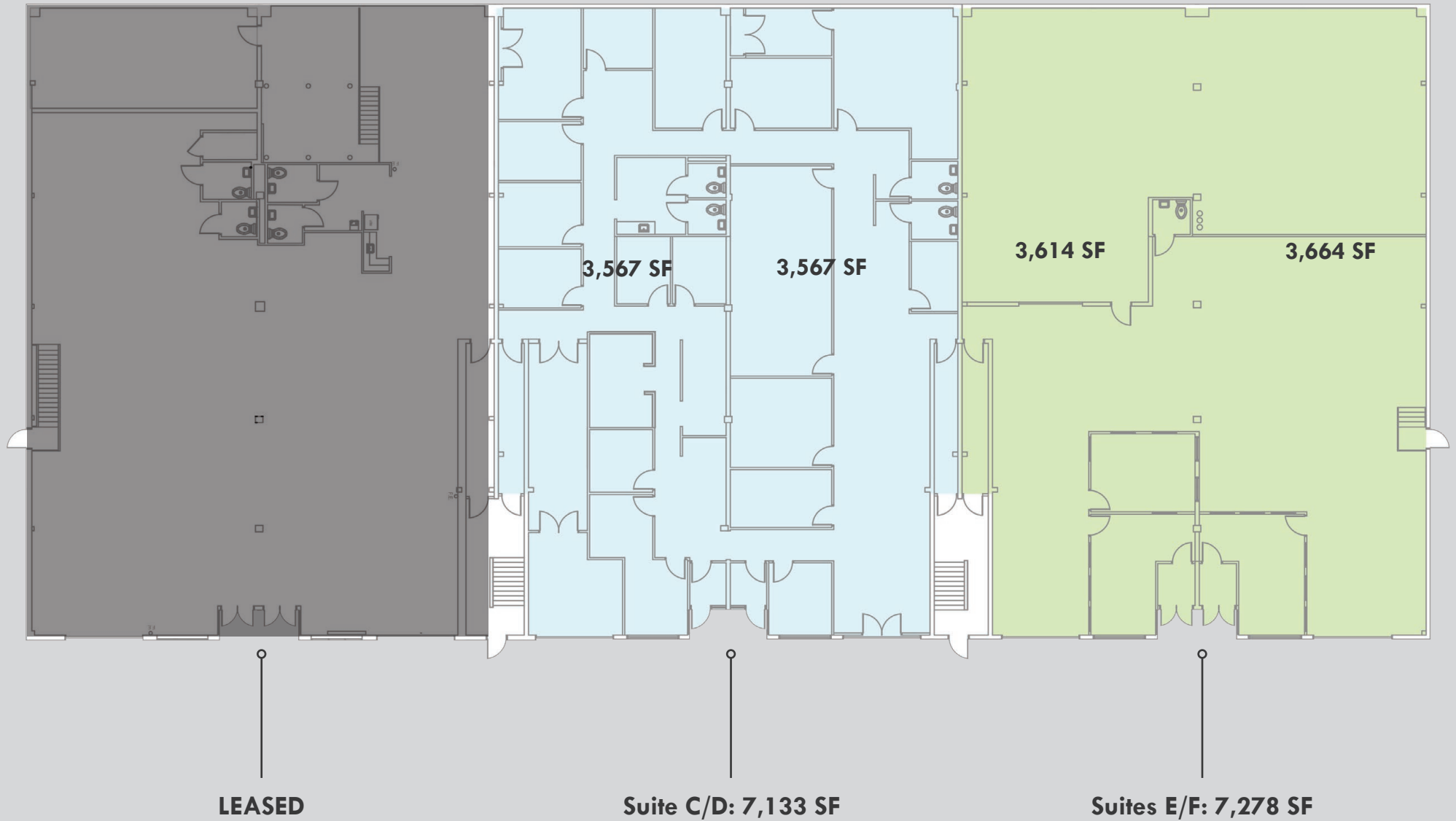

# LOCATION & DEMOGRAPHICS

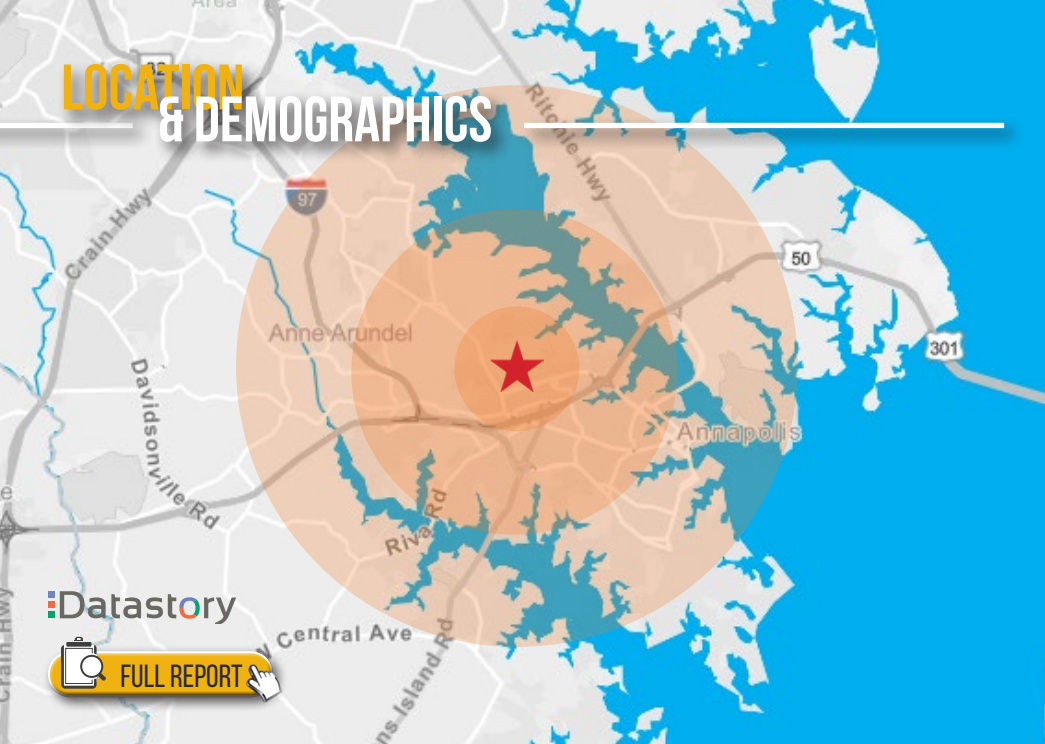

## RESIDENTIAL POPULATION

**6,072**

1 MILE

**43,840**

3 MILES

**115,187**

5 MILES

## NUMBER OF HOUSEHOLDS

**2,895**

1 MILE

**18,621**

3 MILES

**46,457**

5 MILES

## AVERAGE HH SIZE

**1.95**

1 MILE

**2.30**

3 MILES

**2.44**

5 MILES

## MEDIAN AGE

**40.8**

1 MILE

**43.9**

3 MILES

**43.9**

5 MILES

## AVERAGE HH INCOME

**\$161,565**

1 MILE

**\$170,665**

3 MILES

**\$171,580**

5 MILES

## EDUCATION (COLLEGE+)

**76.6%**

1 MILE

**73.2%**

3 MILES

**75.6%**

5 MILES

## EMPLOYMENT (AGE 16+ IN LABOR FORCE)

**97.1%**

1 MILE

**96.8%**

3 MILES

**96.4%**

5 MILES

## DAYTIME POPULATION

**16,587**

1 MILE

**78,891**

3 MILES

**148,814**

5 MILES

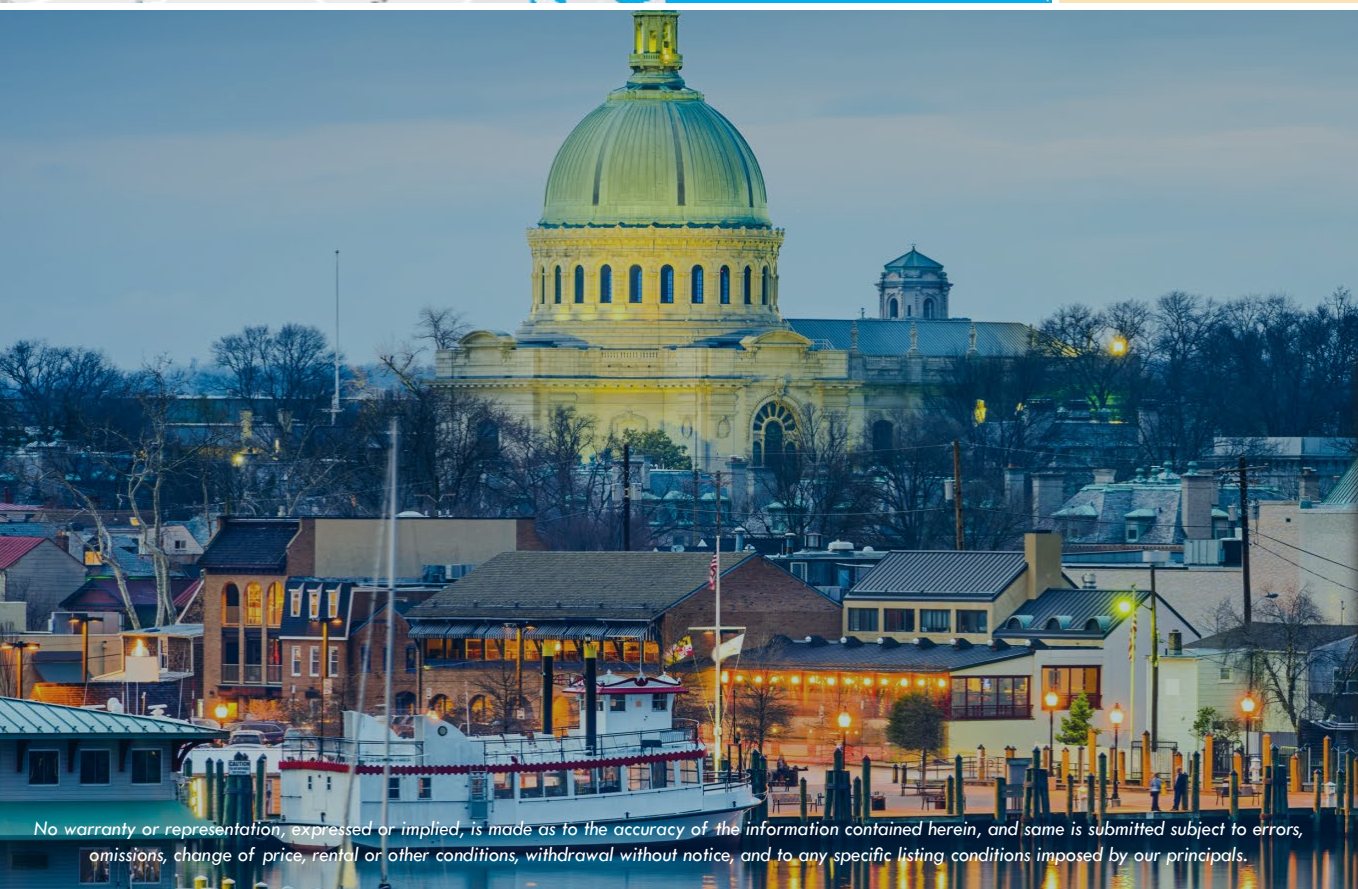

**Bethany Hobbs**

410.953.0359

bhobbs@mackenziecommercial.com

**Trish Farrell**

410.974.9003

tfarrell@mackenziecommercial.com

**David McClatchy**

410.953.0366

dmcclatchy@mackenziecommercial.com



No warranty or representation, expressed or implied, is made as to the accuracy of the information contained herein, and same is submitted subject to errors, omissions, change of price, rental or other conditions, withdrawal without notice, and to any specific listing conditions imposed by our principals.