



2018 ROCK SPRING ROAD

FOREST HILL, MARYLAND 21050

FOR
LEASE



MACKENZIE

COMMERCIAL REAL ESTATE SERVICES, LLC

PROPERTY OVERVIEW

HIGHLIGHTS:

- 2-story retail/office property on Route 24 in Forest Hill, MD
- Excellent visibility
- Large pylon sign available
- Ample on-site parking
- 8 minute drive to Downtown Bel Air's Main Street district
- Easy access to Rt. 1, 22, 23, 924

AVAILABLE:	925-4,425 SF ± (STREET LEVEL)
BUILDING SIZE:	10,669 SF ± (2 STORIES)
TRAFFIC COUNT:	21,930 AADT (ROCK SPRING RD_
PARKING:	50 SURFACE SPACES
ZONING:	B2 (COMMUNITY BUSINESS DISTRICT)
RENTAL RATE:	NEGOTIABLE



FLOOR PLAN: **STREET LEVEL**

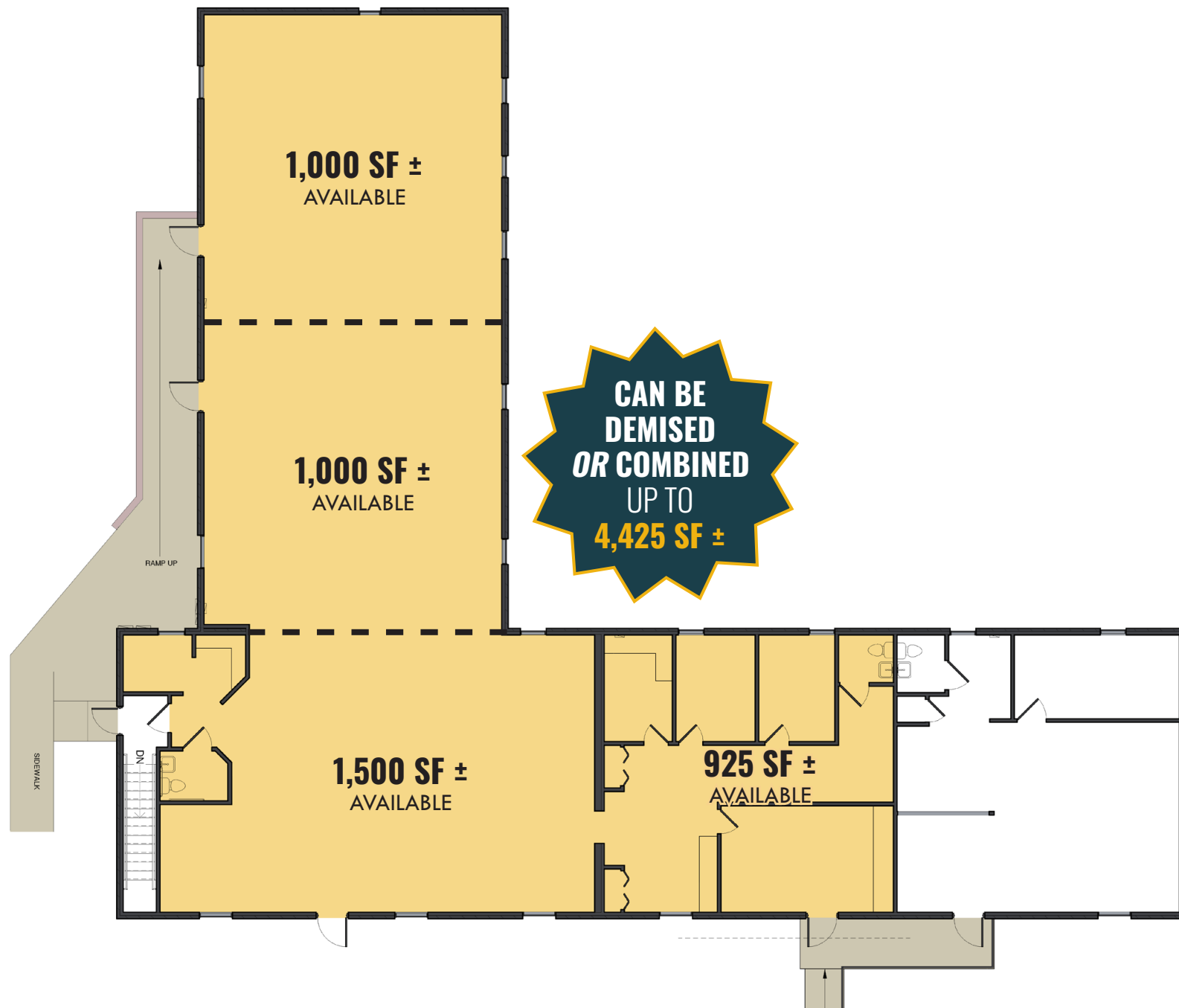

LOCAL BIRDSEYE



LOCAL TRADE AREA

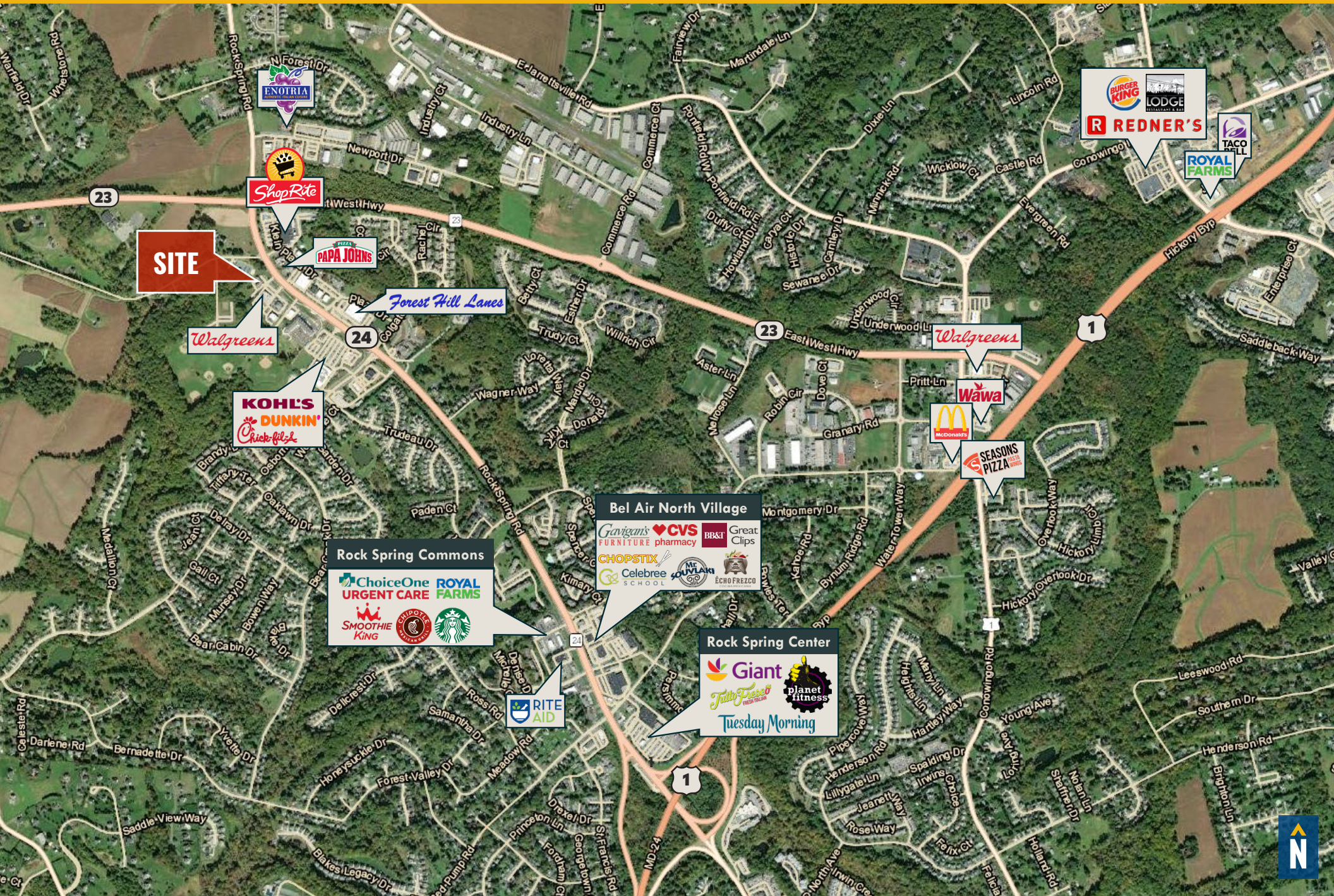

REGIONAL TRADE AREA

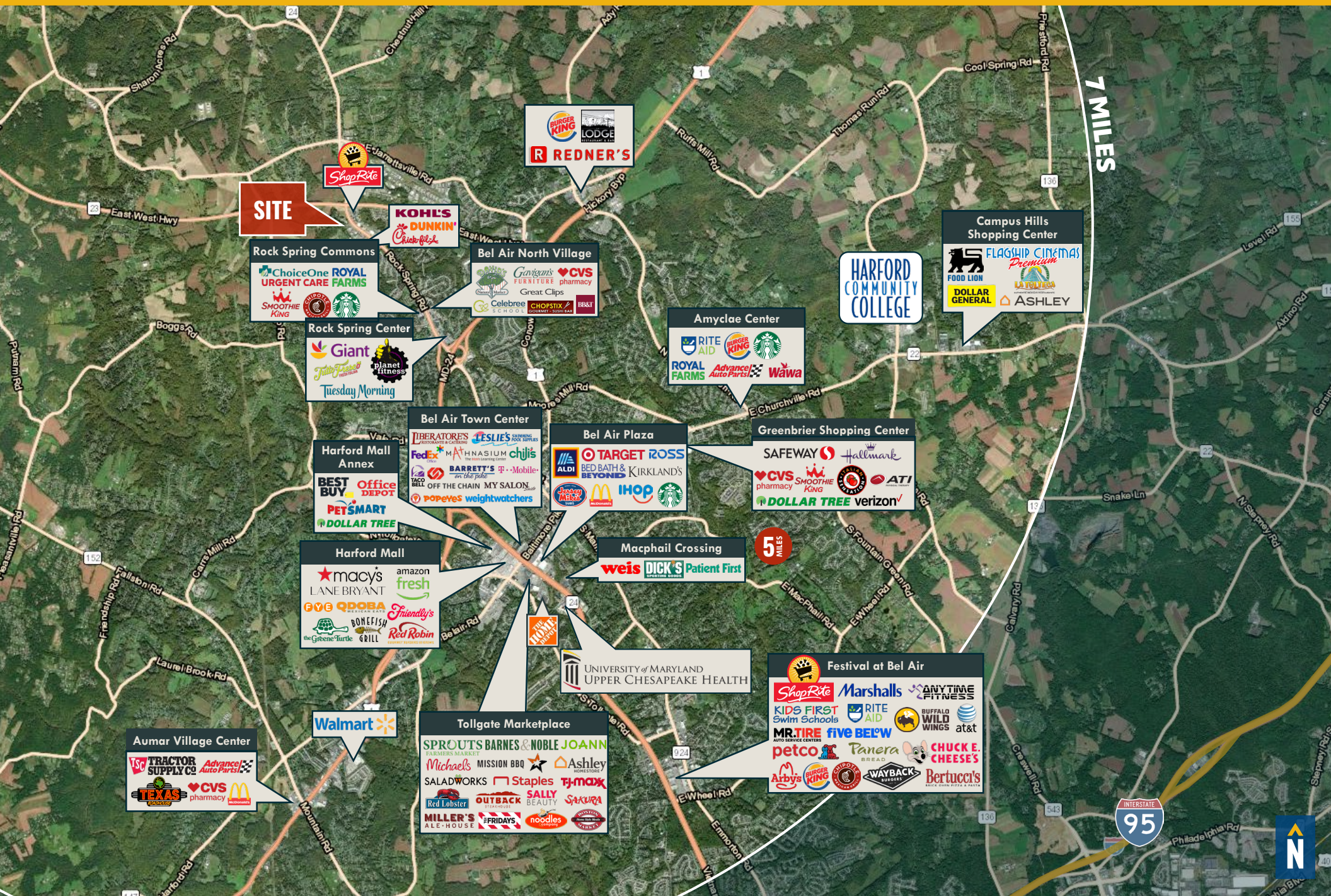

DEMOGRAPHICS

2024

RADIUS:

1 MILE

3 MILES

5 MILES

RESIDENTIAL POPULATION



4,966

35,870

79,325

DAYTIME POPULATION



5,843

28,854

78,829

AVERAGE HOUSEHOLD INCOME



\$148,261

\$151,310

\$149,619

NUMBER OF HOUSEHOLDS



1,939

13,368

29,910

MEDIAN AGE



43.4

42.0

42.5

FULL DEMOS REPORT

DOMINANT LIFESTYLES: 2 MILE RADIUS

esri MORE INFO

26%
SAVVY
SUBURBANITES



These residents are well educated, well read and well capitalized. Largely empty nesters, they have a suburban lifestyle, but also enjoy good food and wine, plus the amenities of the city's cultural events.

Median Age: **45.1**
Median Household Income: **\$108,700**

14%
PROFESSIONAL
PRIDE



These well-educated consumers are career professionals with an annual household income more than twice the US level. Their homes tend to be equipped with home gyms and in-home theaters.

Median Age: **40.8**
Median Household Income: **\$138,100**

13%
PLEASANTVILLE



Prosperous domesticity best describes these settled denizens. They maintain their higher incomes and standard of living with dual incomes, and shop online and in a variety of stores, from upscale to discount.

Median Age: **42.6**
Median Household Income: **\$92,900**

FOR MORE INFO **CONTACT:**



MIKE RUOCCO

SENIOR VICE PRESIDENT & PRINCIPAL

410.494.4868

MRUOCCO@mackenziecommercial.com



PATRICK J. SMITH

REAL ESTATE ADVISOR

847.346.2701

PJSMITH@mackenziecommercial.com



MACKENZIE

COMMERCIAL REAL ESTATE SERVICES, LLC

410-821-8585

**2328 W. Joppa Road, Suite 200
Lutherville, MD 21093**

OFFICES IN: ANNAPOLIS, MD BALTIMORE, MD BEL AIR, MD COLUMBIA, MD **LUTHERVILLE, MD** CHARLOTTESVILLE, VA

www.MACKENZIECOMMERCIAL.com



VISIT **PROPERTY PAGE** FOR MORE INFORMATION.

No warranty or representation, expressed or implied, is made as to the accuracy of the information contained herein, and same is submitted subject to errors, omissions, change of price, rental or other conditions, withdrawal without notice, and to any specific listing conditions imposed by our principals.