

FOR LEASE

 Baltimore County, MD

SEVEN COURTS OFFICE BUILDING

4111 E. JOPPA ROAD | PERRY HALL, MARYLAND 21236

AVAILABLE

Suite 200: 1,500 sf - 6,876 sf

BUILDING SIZE

18,000 sf

ZONING

DR-16 (Density Residential)

PARKING RATIO

4.50/1,000 sf

RENTAL RATE

\$17.50/sf, MG

HIGHLIGHTS

- ▶ Nicely finished office space available immediately
- ▶ Some existing executive style furniture available with lease
- ▶ Ample free surface parking
- ▶ Excellent visibility from Joppa Road
- ▶ Signage available



Matt Mueller

☎ 410.494.6658

✉ mmueller@mackenziecommercial.com

MacKenzie Commercial Real Estate Services, LLC

Henson Ford

☎ 410.494.6657

✉ hford@mackenziecommercial.com

• 410-821-8585

Bill Whitty

☎ 410.494.4862

✉ bwhitty@mackenziecommercial.com

• 2328 W. Joppa Road, Suite 200 | Lutherville-Timonium, Maryland 21093

Joe Bradley

☎ 410.494.4892

✉ jbradley@mackenziecommercial.com

• www.MACKENZIECOMMERCIAL.com

FOR LEASE

Baltimore County, MD

LOCATION

SEVEN COURTS OFFICE BUILDING | 4111 E. JOPPA ROAD | PERRY HALL, MARYLAND 21236

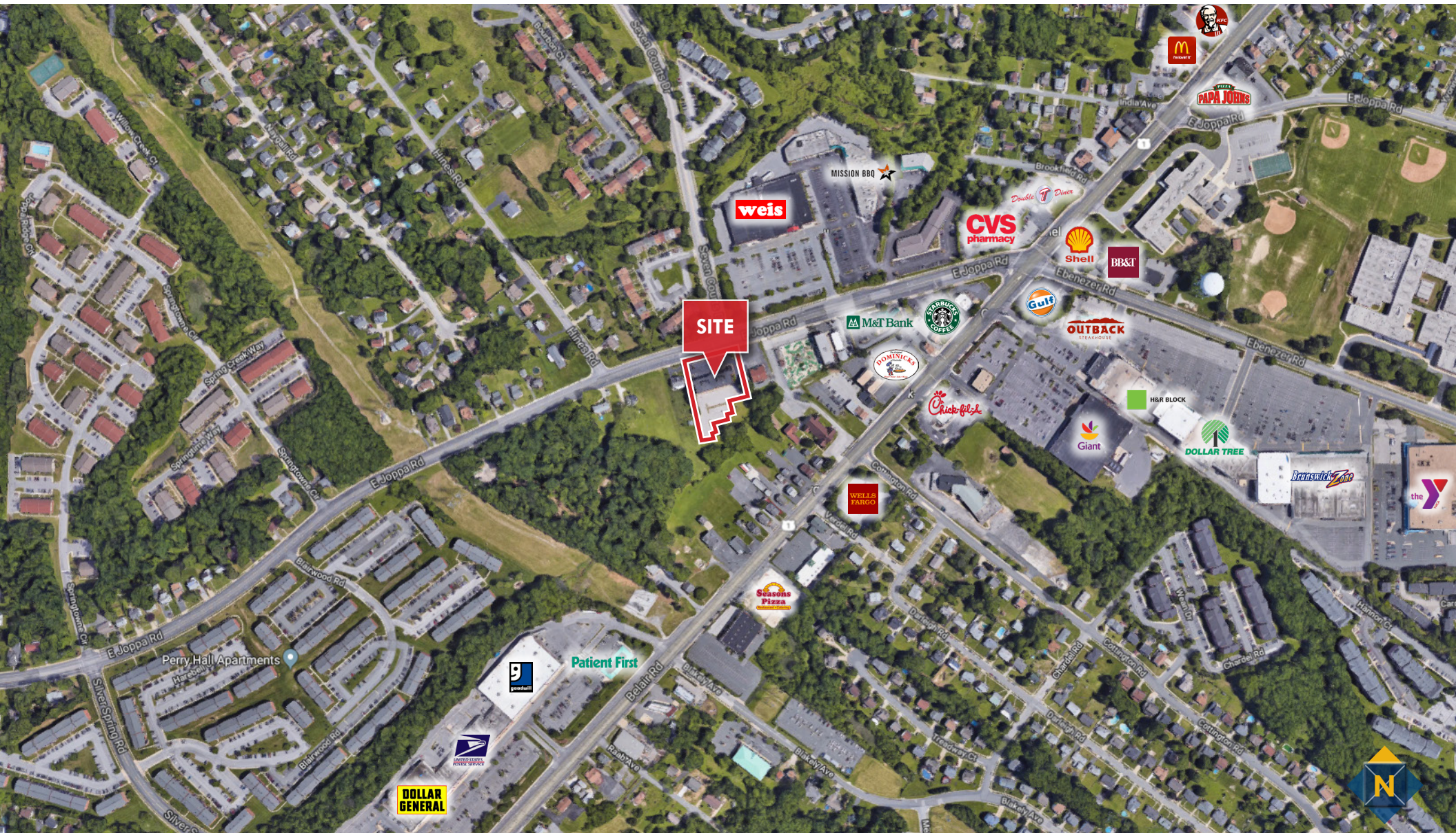

Matt Mueller

410.494.6658

mmueller@mackenziecommercial.com

Mackenzie Commercial Real Estate Services, LLC

Henson Ford

410.494.6657

hford@mackenziecommercial.com

410-821-8585 • 2328 W. Joppa Road, Suite 200 | Lutherville-Timonium, Maryland 21093

Bill Whitty

410.494.4862

bwhitty@mackenziecommercial.com

Joe Bradley

410.494.4892

jbradley@mackenziecommercial.com

www.MACKENZIECOMMERCIAL.com

FOR LEASE

Baltimore County, MD

FLOOR PLAN: SUITE 200

SEVEN COURTS OFFICE BUILDING | 4111 E. JOPPA ROAD | PERRY HALL, MARYLAND 21236

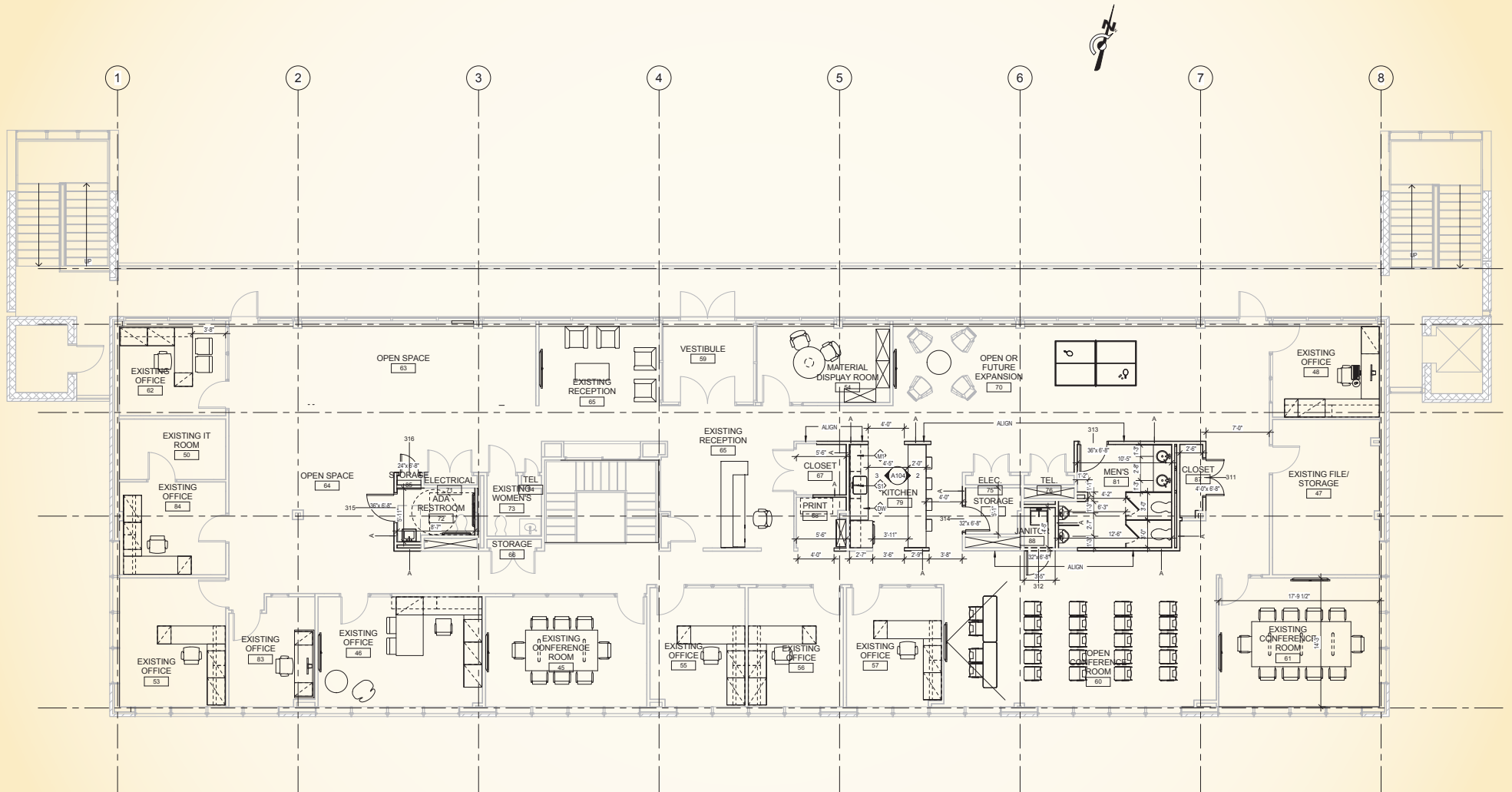

Matt Mueller

☎ 410.494.6658

✉ mmueller@mackenziecommercial.com

Henson Ford

☎ 410.494.6657

✉ hford@mackenziecommercial.com

Bill Whitty

☎ 410.494.4862

✉ bwhitty@mackenziecommercial.com

Joe Bradley

☎ 410.494.4892

✉ jbradley@mackenziecommercial.com