

# SUBLEASE

Baltimore City, Maryland



54,000 SF ±  
AVAILABLE

## WAREHOUSE w/ OFFICE

### DESOTO BUSINESS PARK

3101 WILMARCO AVE | BALTIMORE, MD 21223



**Andrew Meeder, SIOR** | Senior Vice President & Principal  
☎ 410.494.4881 ✉ [ameeder@mackenziecommercial.com](mailto:ameeder@mackenziecommercial.com)

MacKenzie Commercial Real Estate Services, LLC • 443-573-3200 • 111 S. Calvert Street, Suite 2800 | Baltimore, Maryland 21202 • [www.MACKENZIECOMMERCIAL.com](http://www.MACKENZIECOMMERCIAL.com)

**Daniel Hudak, SIOR** | Senior Vice President & Principal  
☎ 443.573.3205 ✉ [dhudak@mackenziecommercial.com](mailto:dhudak@mackenziecommercial.com)



# SUBLEASE

Baltimore City, Maryland

# WAREHOUSE SPACE WITH OFFICE

DESOTO BUSINESS PARK | 3101 WILMARCO AVENUE | BALTIMORE, MARYLAND 21223

## AVAILABLE

54,000 sf ±

- » 50,625 sf ± warehouse space
- » 3,375 sf ± office space

## SUBLEASE TERM THROUGH

May 31, 2024

*(Longer term avail. with Landlord)*

## CLEAR HEIGHT

24' ±

## LOADING

Five (5) dock doors

## ZONING

I-1 (Light Industrial District)

## POWER

3 Phase (120/208 volts; 400amps)

## RENTAL RATE

Negotiable

## HIGHLIGHTS

- ▶ Situated within Desoto Industrial Park (Building A)
- ▶ Easy access to I-95, I-295, I-695, Route 1 (Wilkins Ave)



# SUBLEASE

Baltimore City, Maryland

# FLOOR PLAN: WAREHOUSE

DESOTO BUSINESS PARK | 3101 WILMARCO AVENUE | BALTIMORE, MARYLAND 21223

50,625 SF ±

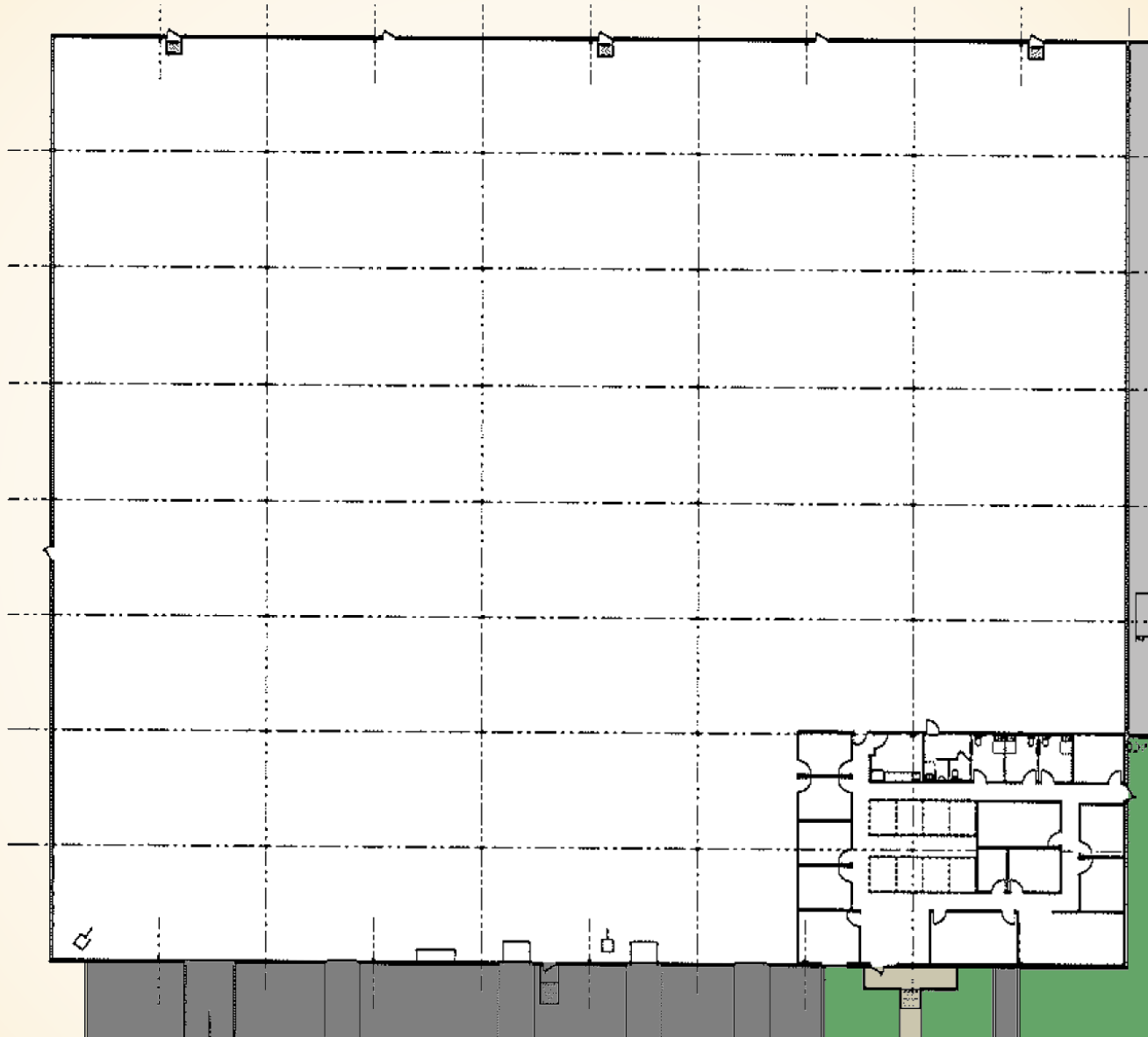



# SUBLEASE



Baltimore City, Maryland

# FLOOR PLAN: OFFICE

DESOTO BUSINESS PARK | 3101 WILMARCO AVENUE | BALTIMORE, MARYLAND 21223

3,375 SF ±

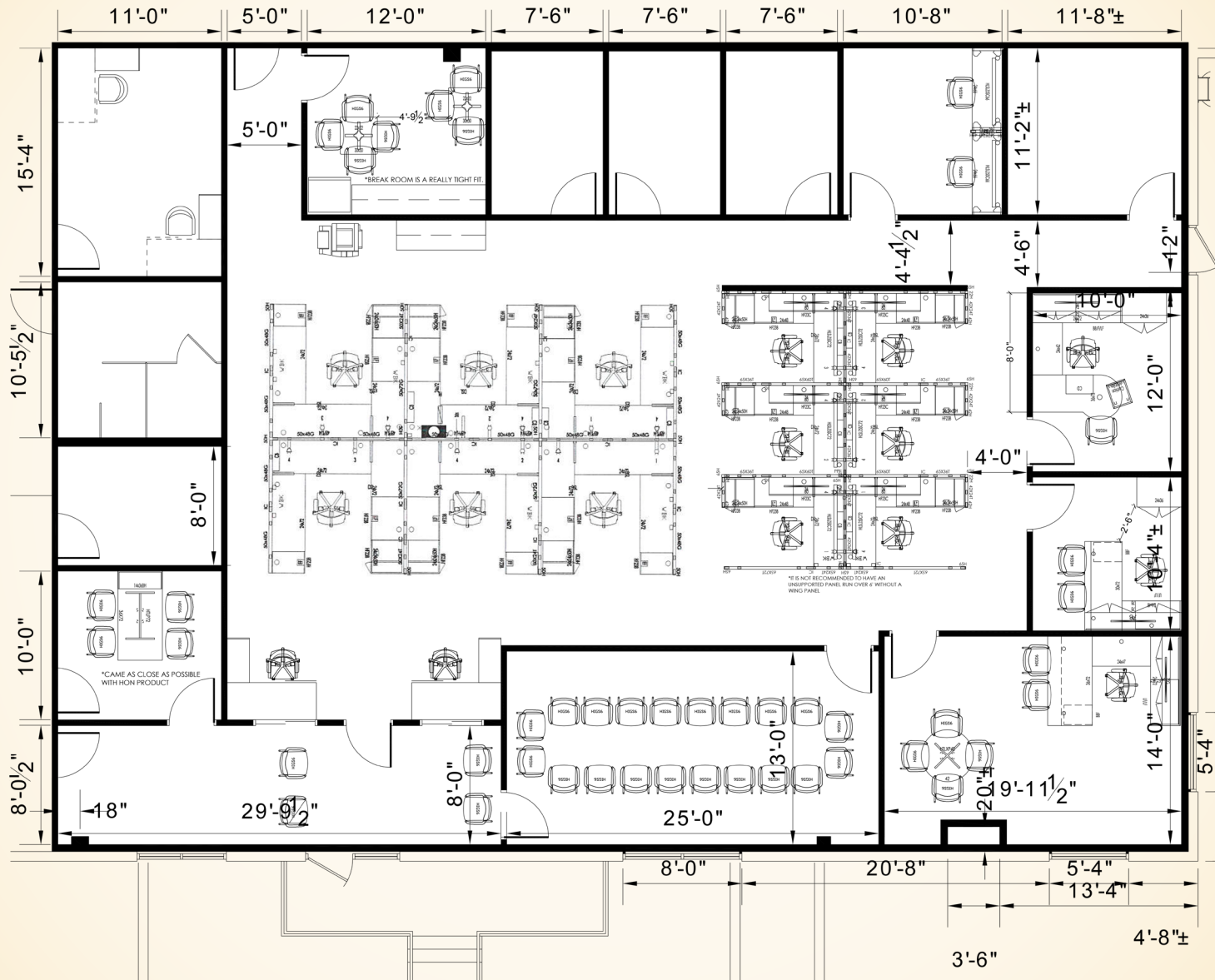



# SUBLEASE



Baltimore City, Maryland

# TRADE AREA

DESOTO BUSINESS PARK | 3101 WILMARCO AVENUE | BALTIMORE, MARYLAND 21223

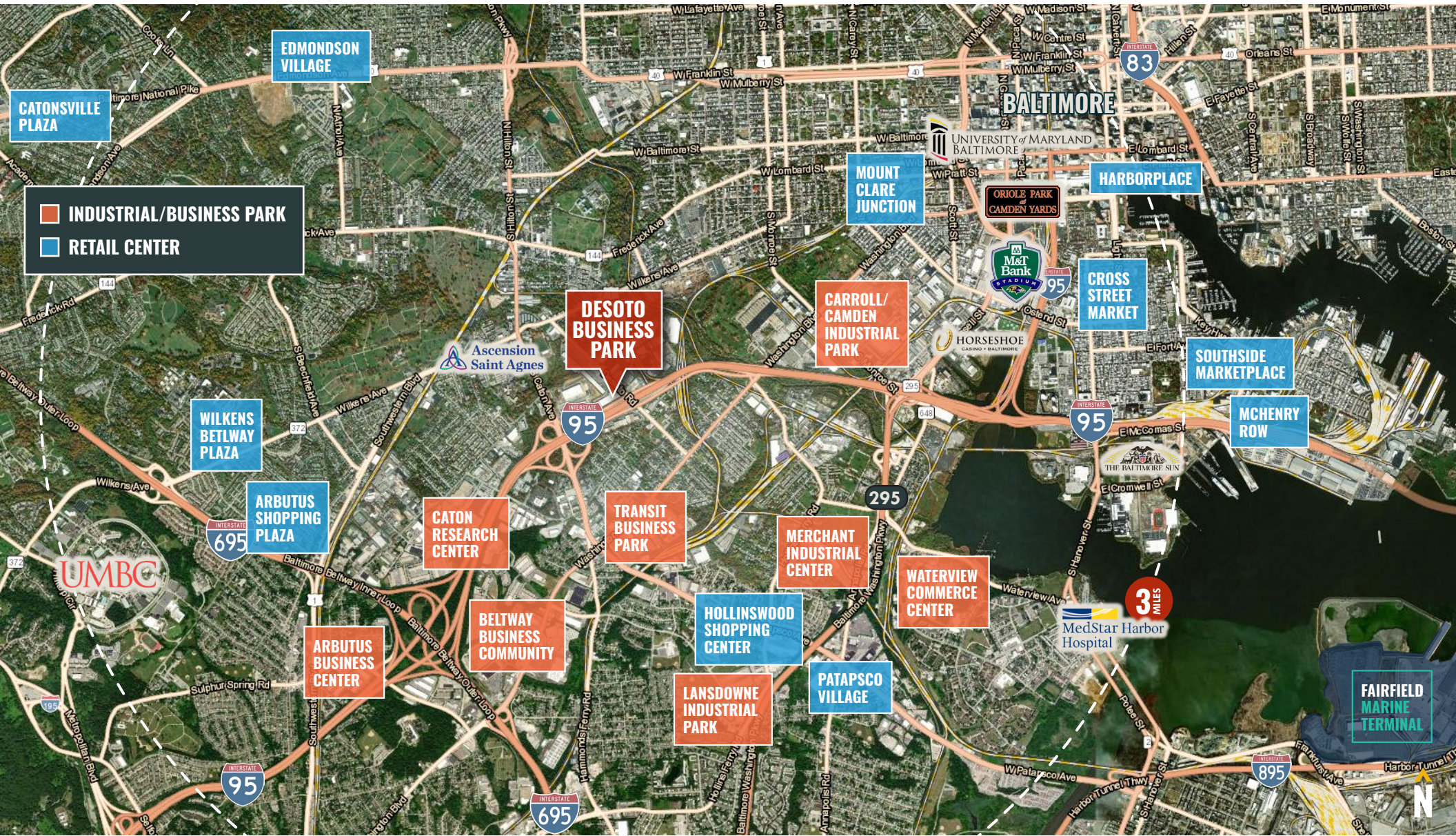



# SUBLEASE



Baltimore City, Maryland

# LOCATION

DESOTO BUSINESS PARK | 3101 WILMARCO AVENUE | BALTIMORE, MARYLAND 21223

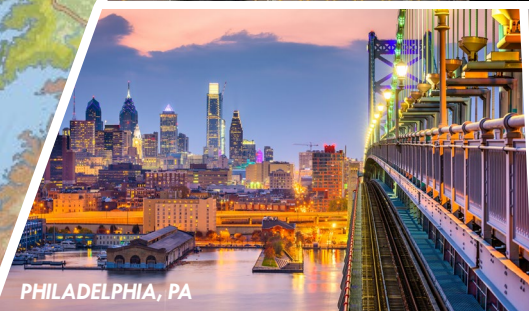
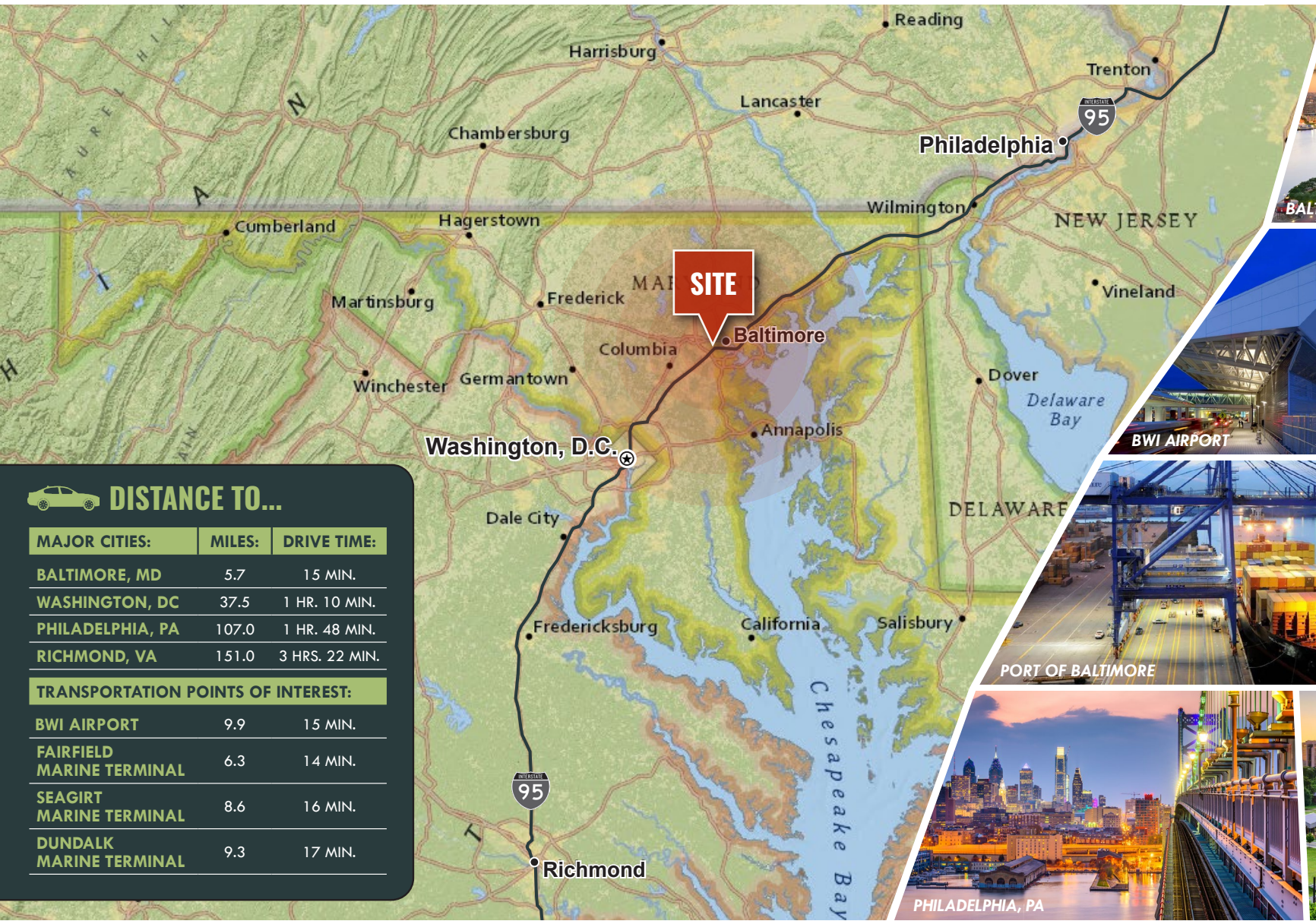

## DISTANCE TO...

MAJOR CITIES:	MILES:	DRIVE TIME:
BALTIMORE, MD	5.7	15 MIN.
WASHINGTON, DC	37.5	1 HR. 10 MIN.
PHILADELPHIA, PA	107.0	1 HR. 48 MIN.
RICHMOND, VA	151.0	3 HRS. 22 MIN.

TRANSPORTATION POINTS OF INTEREST:	MILES:	DRIVE TIME:
BWI AIRPORT	9.9	15 MIN.
FAIRFIELD MARINE TERMINAL	6.3	14 MIN.
SEAGIRT MARINE TERMINAL	8.6	16 MIN.
DUNDALK MARINE TERMINAL	9.3	17 MIN.





**ANDREW MEEDER, SIOR**  
SENIOR VICE PRESIDENT & PRINCIPAL  
MACKENZIE COMMERCIAL REAL ESTATE SERVICES, LLC

**410.494.4881**  
[AMEEDER@MACKENZIECOMMERCIAL.COM](mailto:AMEEDER@MACKENZIECOMMERCIAL.COM)



**DANIEL HUDAK, SIOR**  
SENIOR VICE PRESIDENT & PRINCIPAL  
MACKENZIE COMMERCIAL REAL ESTATE SERVICES, LLC

**443.573.3205**  
[DHUDAK@MACKENZIECOMMERCIAL.COM](mailto:DHUDAK@MACKENZIECOMMERCIAL.COM)

MacKenzie Commercial Real Estate Services, LLC • 410-821-8585 • 111 S. Calvert Street | Baltimore, Maryland 21202 • [www.MACKENZIECOMMERCIAL.com](http://www.MACKENZIECOMMERCIAL.com)

No warranty or representation, expressed or implied, is made as to the accuracy of the information contained herein, and same is submitted subject to errors, omissions, change of price, rental or other conditions, withdrawal without notice, and to any specific listing conditions imposed by our principals.

