



INDUSTRIAL WAREHOUSE FOR LEASE

7120-7132 AMBASSADOR ROAD
WINDSOR MILL, MARYLAND 21224



Chris Boland | Senior Real Estate Advisor
☎ 410.494.6644 ✉ cboland@mackenziecommercial.com
MacKenzie Commercial Real Estate Services, LLC • 410-821-8585 • 2328 W. Joppa Road, Suite 200 | Lutherville-Timonium, Maryland 21093 • www.MACKENZIECOMMERCIAL.com

Patrick Smith, SIOR | Vice President
☎ 410.494.4866 ✉ psmith@mackenziecommercial.com
MacKenzie Commercial Real Estate Services, LLC • 410-821-8585 • 2328 W. Joppa Road, Suite 200 | Lutherville-Timonium, Maryland 21093 • www.MACKENZIECOMMERCIAL.com

FOR LEASE

Baltimore County, MD

RUTHERFORD BUSINESS CENTER

7120-7132 AMBASSADOR ROAD | WINDSOR MILL, MARYLAND 21244



AVAILABLE

Suite 7120: 9,810 sf (Available 10/1/25)

Suite 7124: 6,451 sf

Suite 7128: 6,628 sf - 16,057 sf

All suites have the ability to be combined up to a total of 32,318 sf

1.0 AC Lot: 136 Spaces for Lease
(Available 5/1/2024)

BUILDING SIZE

47,531 sf

ZONING

ML (Manufacturing)

HIGHLIGHTS

- ▶ Fully conditioned
- ▶ Dock & Drive-In
- ▶ Wet Sprinkler System
- ▶ Easy access to I-695
- ▶ 16' - 18' clear height
- ▶ OpEx: \$2.85/psf



Chris Boland | Senior Real Estate Advisor

☎ 410.494.6644 ✉ cboland@mackenziecommercial.com

Mackenzie Commercial Real Estate Services, LLC • 410-821-8585 • 2328 W. Joppa Road, Suite 200 | Lutherville-Timonium, Maryland 21103 • www.MACKENZIECOMMERCIAL.com

Patrick Smith, SIOR | Vice President

☎ 410.494.4866 ✉ psmith@mackenziecommercial.com

FOR LEASE

Baltimore County, MD

FLOOR PLAN

RUTHERFORD BUSINESS CENTER | 7120-7132 AMBASSADOR ROAD | WINDSOR MILL, MARYLAND 21244

- Suite 7120: 9,810 sf
- Suite 7124: 6,451 sf
- Suite 7128: 6,628 sf - 16,057 sf

All suites have the ability to be combined up to a total of 32,318 sf

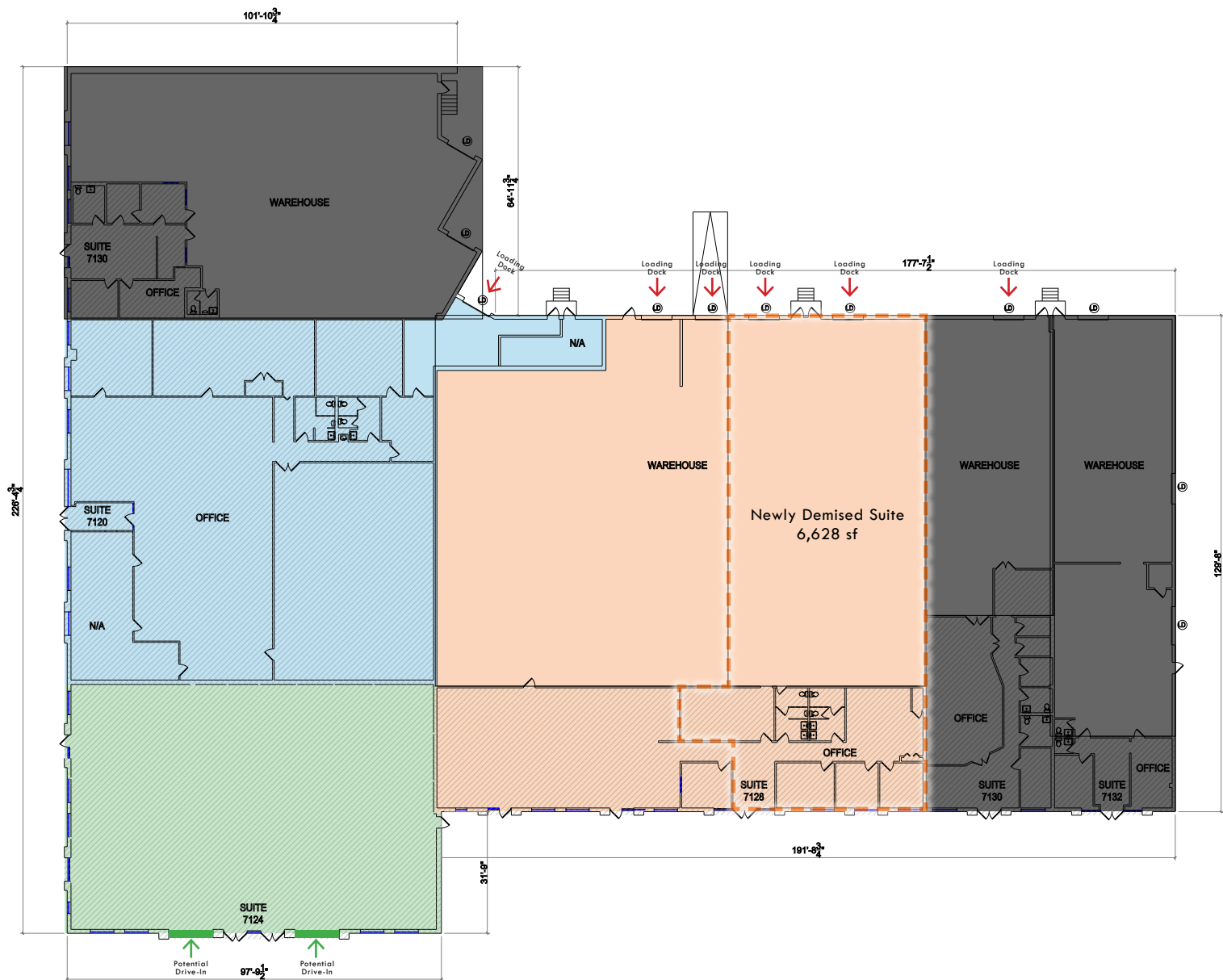

FOR LEASE

Baltimore County, MD

BIRDSEYE

RUTHERFORD BUSINESS CENTER | 7120-7132 AMBASSADOR ROAD | WINDSOR MILL, MARYLAND 21244



FOR LEASE

Baltimore County, MD

TRADE AREA

RUTHERFORD BUSINESS CENTER | 7120-7132 AMBASSADOR ROAD | WINDSOR MILL, MARYLAND 21244

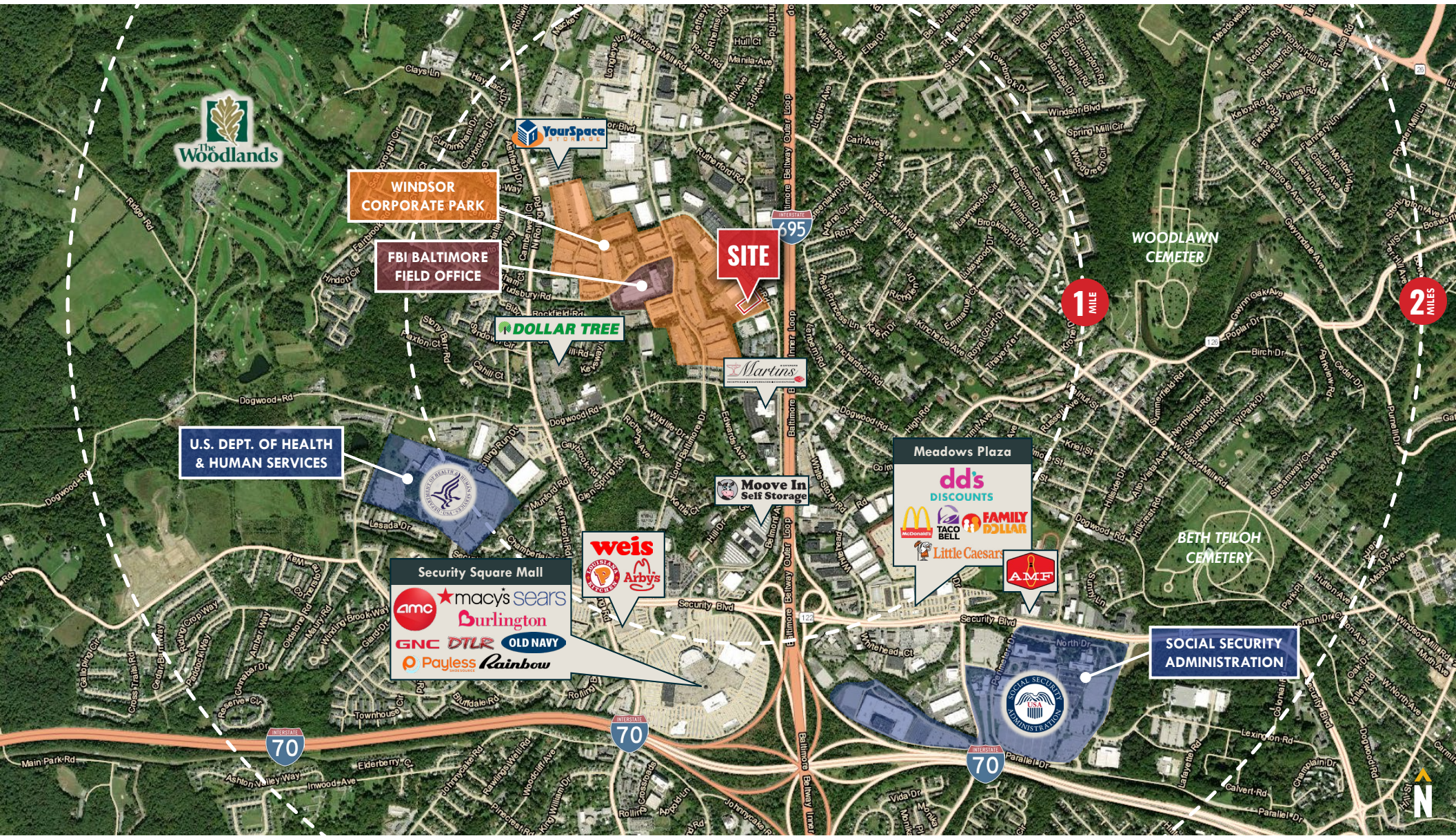



CHRIS BOLAND

SENIOR REAL ESTATE ADVISOR
MACKENZIE COMMERCIAL REAL ESTATE SERVICES, LLC

410.494.6644
CBOLAND@MACKENZIECOMMERCIAL.COM



PATRICK SMITH, SIOR

VICE PRESIDENT
MACKENZIE COMMERCIAL REAL ESTATE SERVICES, LLC

410.494.4866
PSMITH@MACKENZIECOMMERCIAL.COM

MacKenzie Commercial Real Estate Services, LLC • 410-821-8585 • 2328 W. Joppa Road, Suite 200 | Lutherville, Maryland 21093 • www.MACKENZIECOMMERCIAL.com

No warranty or representation, expressed or implied, is made as to the accuracy of the information contained herein, and same is submitted subject to errors, omissions, change of price, rental or other conditions, withdrawal without notice, and to any specific listing conditions imposed by our principals.