

FOR LEASE



Anne Arundel County, MD

WAREHOUSE/FLEX SPACE

930 INTERNATIONAL DRIVE

LINTHICUM HEIGHTS, MARYLAND 21090

32,384 SF ±
AVAILABLE

Andrew Meeder, SIOR

☎ 410.494.4881

✉ ameeder@mackenziecommercial.com

Daniel Hudak, SIOR

☎ 443.573.3205

✉ dhudak@mackenziecommercial.com

Patrick Smith, SIOR

☎ 410.494.4866

✉ psmith@mackenziecommercial.com

Chris Boland

☎ 410.494.6644

✉ cboland@mackenziecommercial.com

FOR LEASE

Anne Arundel County, MD

WAREHOUSE/FLEX SPACE

930 INTERNATIONAL DRIVE | LINTHICUM HEIGHTS, MARYLAND 21090

AVAILABLE

32,384 sf ±

ZONING

W1 (Industrial Park District)

CEILING HEIGHT

17' ±

COLUMN SPACING

30' x 40' ±

LOADING

Six (6) 8' x 10' doors (Proposed)

RENTAL RATE

Negotiable

HIGHLIGHTS

- ▶ 120' ± loading court
- ▶ 3 phase power (277/480V and 120/208V)
- ▶ Excellent access to I-295, I-695, I-95 and I-895
- ▶ BWI, MARC train, light rail and major hotels located nearby
- ▶ Adjacent to Northrop Grumman headquarters (4 million sf)



Andrew Meeder, SIOR

☎ 410.494.4881

✉ ameeder@mackenziecommercial.com

Daniel Hudak, SIOR

☎ 443.573.3205

✉ dhudak@mackenziecommercial.com

Patrick Smith, SIOR

☎ 410.494.4866

✉ psmith@mackenziecommercial.com

Chris Boland

☎ 410.494.6644

✉ cboland@mackenziecommercial.com

MacKenzie Commercial Real Estate Services, LLC • 443-573-3200 • 111 S. Calvert Street, Suite 2800 | Baltimore, Maryland 21202

• www.MACKENZIECOMMERCIAL.com

FOR LEASE



Anne Arundel County, MD

FLOOR PLAN

930 INTERNATIONAL DRIVE | LINTHICUM HEIGHTS, MARYLAND 21090

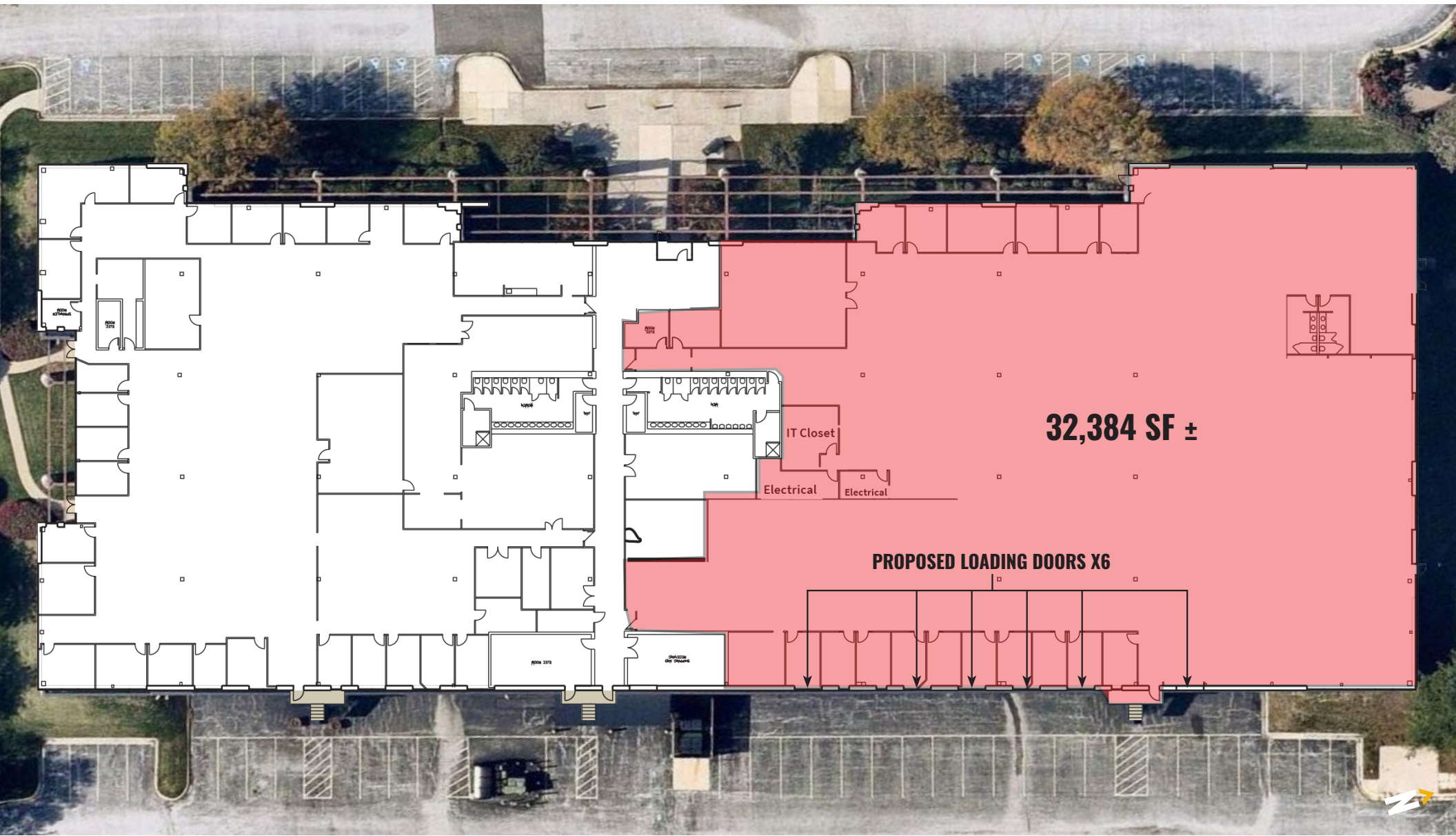

Andrew Meeder, SIOR

☎ 410.494.4881

✉ ameeder@mackenziecommercial.com

Daniel Hudak, SIOR

☎ 443.573.3205

✉ dhudak@mackenziecommercial.com

Patrick Smith, SIOR

☎ 410.494.4866

✉ psmith@mackenziecommercial.com

Chris Boland

☎ 410.494.6644

✉ cboland@mackenziecommercial.com

FOR LEASE

Anne Arundel County, MD

LOCAL BIRDSEYE

930 INTERNATIONAL DRIVE | LINTHICUM HEIGHTS, MARYLAND 21090



Andrew Meeder, SIOR

410.494.4881

ameeder@mackenziecommercial.com

Daniel Hudak, SIOR

443.573.3205

dhudak@mackenziecommercial.com

Patrick Smith, SIOR

410.494.4866

psmith@mackenziecommercial.com

Chris Boland

410.494.6644

cboland@mackenziecommercial.com

FOR LEASE

Anne Arundel County, MD

TRADE AREA

930 INTERNATIONAL DRIVE | LINTHICUM HEIGHTS, MARYLAND 21090



FOR LEASE

Anne Arundel County, MD

LOCATION

930 INTERNATIONAL DRIVE | LINTHICUM HEIGHTS, MARYLAND 21090

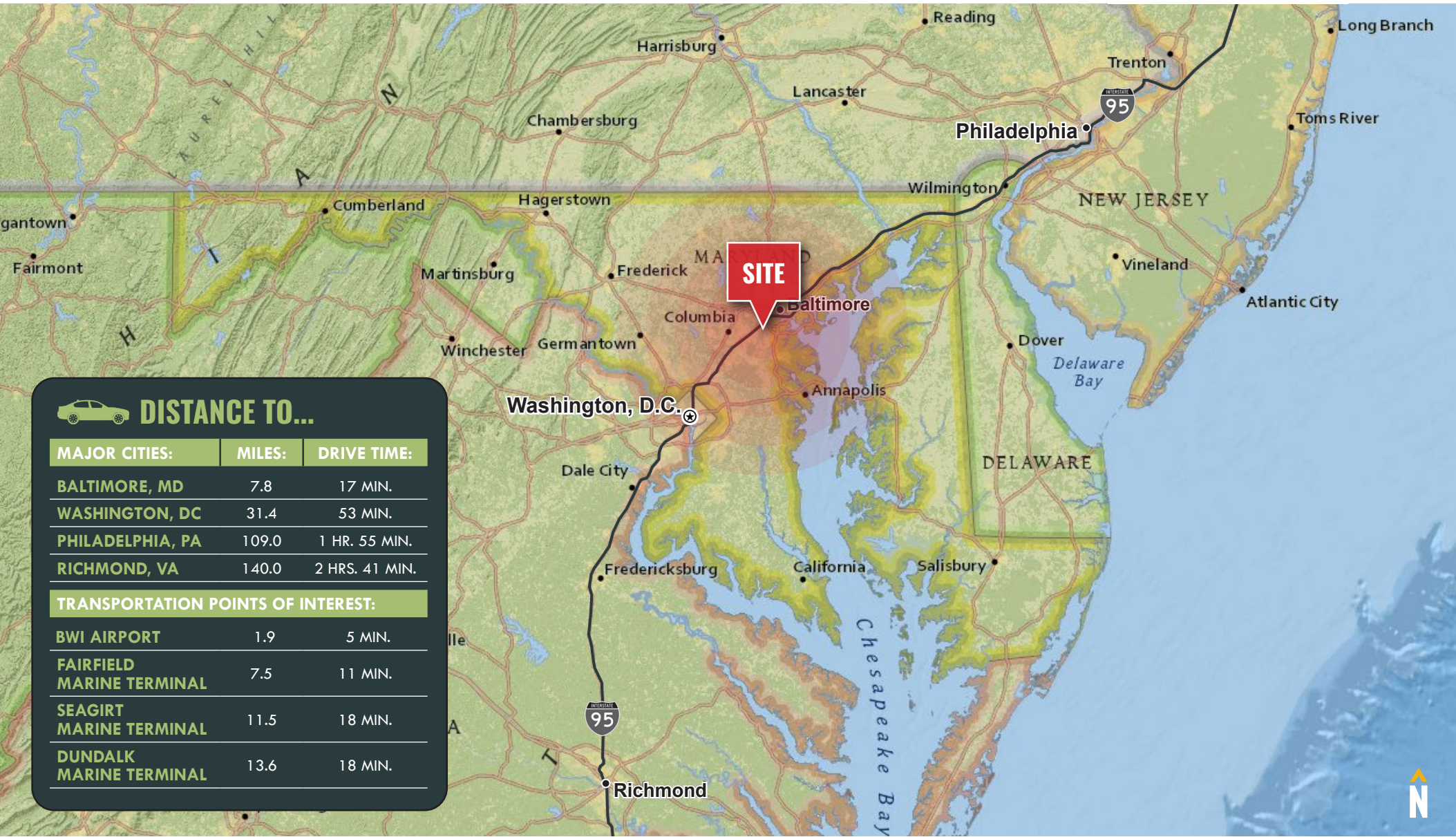

DISTANCE TO...

MAJOR CITIES:	MILES:	DRIVE TIME:
BALTIMORE, MD	7.8	17 MIN.
WASHINGTON, DC	31.4	53 MIN.
PHILADELPHIA, PA	109.0	1 HR. 55 MIN.
RICHMOND, VA	140.0	2 HRS. 41 MIN.
TRANSPORTATION POINTS OF INTEREST:		
BWI AIRPORT	1.9	5 MIN.
FAIRFIELD MARINE TERMINAL	7.5	11 MIN.
SEAGIRT MARINE TERMINAL	11.5	18 MIN.
DUNDALK MARINE TERMINAL	13.6	18 MIN.

PROPOSED LOADING DOORS X6



ANDREW MEEDER, SIOR

SENIOR VICE PRESIDENT & PRINCIPAL

MACKENZIE COMMERCIAL REAL ESTATE SERVICES, LLC

410.494.4881

AMEEDER@MACKENZIECOMMERCIAL.COM



DANIEL HUDAK, SIOR

SENIOR VICE PRESIDENT & PRINCIPAL

MACKENZIE COMMERCIAL REAL ESTATE SERVICES, LLC

443.573.3205

DHUDAK@MACKENZIECOMMERCIAL.COM



PATRICK SMITH, SIOR

VICE PRESIDENT

MACKENZIE COMMERCIAL REAL ESTATE SERVICES, LLC

410.494.4866

PSMITH@MACKENZIECOMMERCIAL.COM



CHRIS BOLAND

SENIOR REAL ESTATE ADVISOR

MACKENZIE COMMERCIAL REAL ESTATE SERVICES, LLC

410.494.6644

CBOLAND@MACKENZIECOMMERCIAL.COM

MacKenzie Commercial Real Estate Services, LLC • 410-821-8585 • 111 S. Calvert Street | Baltimore, Maryland 21202 • www.MACKENZIECOMMERCIAL.com

No warranty or representation, expressed or implied, is made as to the accuracy of the information contained herein, and same is submitted subject to errors, omissions, change of price, rental or other conditions, withdrawal without notice, and to any specific listing conditions imposed by our principals.