



# MCLEAN RIDGE IV

8098 SANDPIPER CIRCLE | WHITE MARSH, MARYLAND 21236

FOR  
LEASE



**MACKENZIE**

COMMERCIAL REAL ESTATE SERVICES, LLC

# PROPERTY OVERVIEW

## HIGHLIGHTS:

- Single story office building with individual suite entrances
- Efficient floor plan
- Convenient access to I-95, I-695, Route 40, and Route 7 (Philadelphia Road)
- Nearby Amenities include White Marsh Mall, The Avenue at White Marsh, Nottingham Commons, hotels, banking, and more
- Established White Marsh landlord

AVAILABLE:

SUITE D: 2,724 SF

PARKING:

5.6/1,000 SF

ZONING:

ML

RENTAL RATE:

\$16.00/SF NNN



# FLOOR PLAN: SUITE D

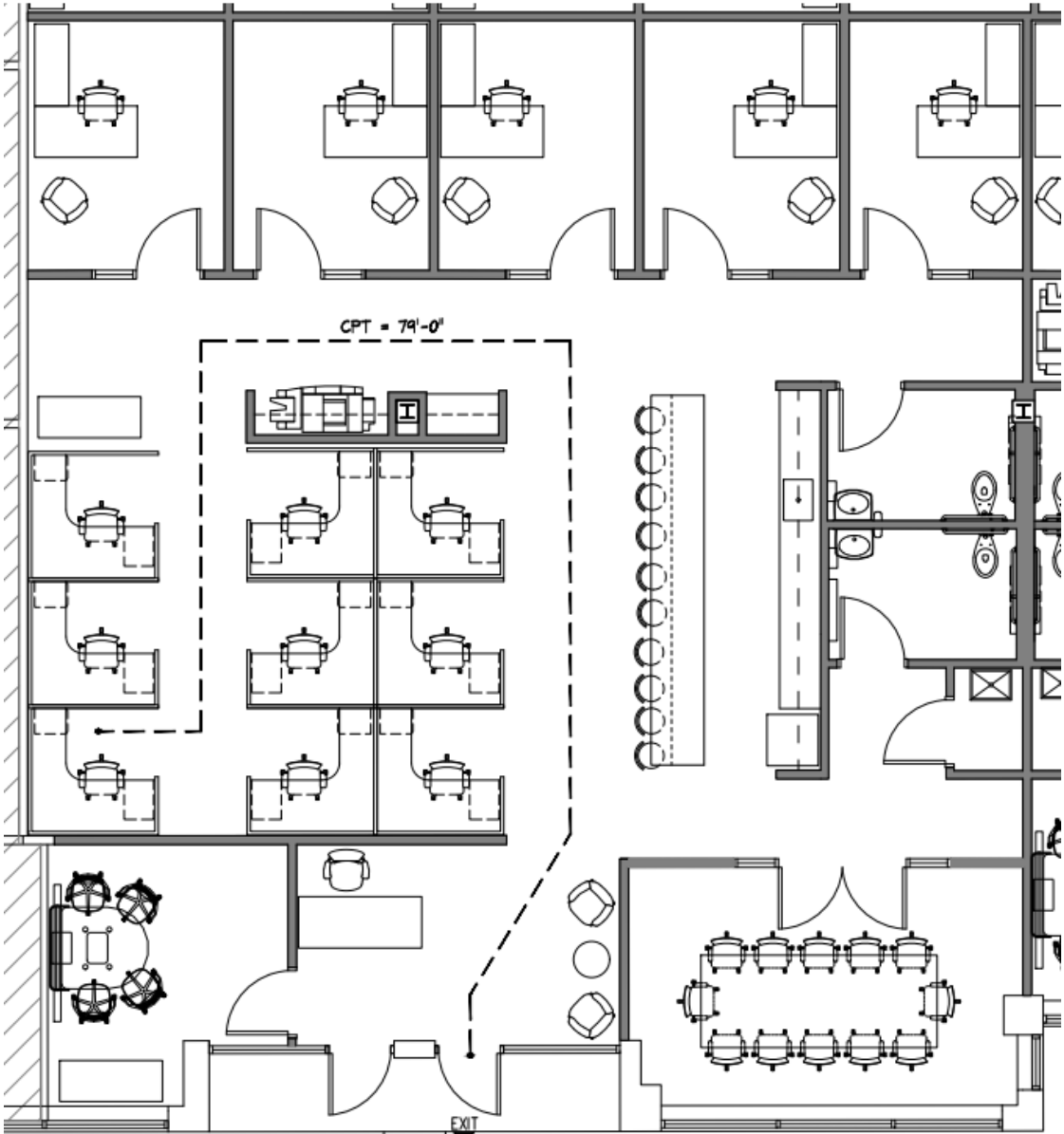

**SUITE D**  
2,724 SF

# LOCAL BIRDSEYE



43

White Marsh Mall

- Buffalo Wild Wings Grill & Bar
- Chick-fil-A
- Macy's
- Dave & Buster's
- Popeyes
- Olive Garden
- Boscov's
- Cinnabon

THE AVENUE at White Marsh

- Starbucks Coffee
- Ulta Beauty
- Nike Clearance Store
- AMC Theatres
- Banditos Bar & Kitchen
- Bar Louie
- Barnes & Noble Booksellers
- The Local

95

HONEYGO BLVD

Avenue Grand  
SMART. STYLISH. EXCLUSIVELY GRAND.

SANDPIPER CIR

SITE

TOWN CENTER DR



# FOR MORE INFO **CONTACT:**



## **MATT MUELLER**

*SENIOR VICE PRESIDENT & PRINCIPAL*

**410.494.6658**

**MMUELLER@mackenziecommercial.com**



## **JOE BRADLEY**

*SENIOR VICE PRESIDENT & PRINCIPAL*

**410.494.4892**

**JBRADLEY@mackenziecommercial.com**



## **HENSON FORD**

*VICE PRESIDENT*

**410.494.6657**

**HFORD@mackenziecommercial.com**



# **MACKENZIE**

COMMERCIAL REAL ESTATE SERVICES, LLC

**410-821-8585**

**2328 W. Joppa Road, Suite 200**

**Lutherville, MD 21093**

OFFICES IN:

**ANNAPOLIS**

**BALTIMORE**

**BEL AIR**

**COLUMBIA**

**LUTHERVILLE**

**[www.MACKENZIECOMMERCIAL.com](http://www.MACKENZIECOMMERCIAL.com)**



VISIT **PROPERTY PAGE** FOR MORE INFORMATION.



*No warranty or representation, expressed or implied, is made as to the accuracy of the information contained herein, and same is submitted subject to errors, omissions, change of price, rental or other conditions, withdrawal without notice, and to any specific listing conditions imposed by our principals.*