

# FOR LEASE

Baltimore County, MD

# DUNDALK PROFESSIONAL CENTER

1576 MERRITT BOULEVARD | BALTIMORE, MARYLAND, 21222

## AVAILABLE

Suite 10: 1,086 sf

## Proposed Addition

Build-To-Suit: 15,000 sf

(Available in 18-24 months)

## RENTAL RATE

Negotiable

## TERM

5 - 10 Years

## PARKING RATIO

4.72 : 1,000 sf

## NEARBY AMENITIES

Dining, Retail, Banking, Personal Services

## HIGHLIGHTS

- ▶ Existing medical build-outs
- ▶ Ample parking (170 spaces serve the property)
- ▶ Conveniently located on Merritt Boulevard, just off I-695
- ▶ Pharmacy on-site



**Joe Bradley**

☎ 410.494.4892

✉ jbradley@mackenziecommercial.com

**Matt Mueller**

☎ 410.494.6658

✉ mmueller@mackenziecommercial.com

**Henson Ford**

☎ 410.494.6657

✉ hford@mackenziecommercial.com

**Dylan Bozel**

☎ 410.494.4896

✉ dbozel@mackenziecommercial.com

Mackenzie Commercial Real Estate Services, LLC • 410-821-8585 • 2328 W. Joppa Road, Suite 200 | Lutherville-Timonium, Maryland 21093 • www.MACKENZIECOMMERCIAL.com

# FOR LEASE

Baltimore County, MD

# LOCATION

DUNDALK PROFESSIONAL CENTER | 1576 MERRITT BOULEVARD | BALTIMORE, MARYLAND 21222

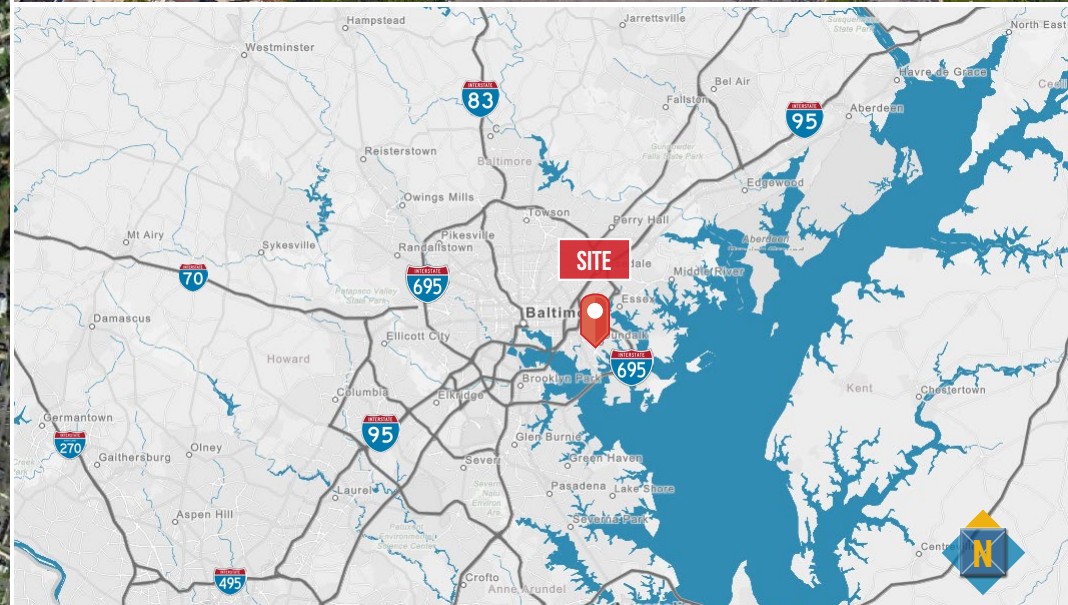
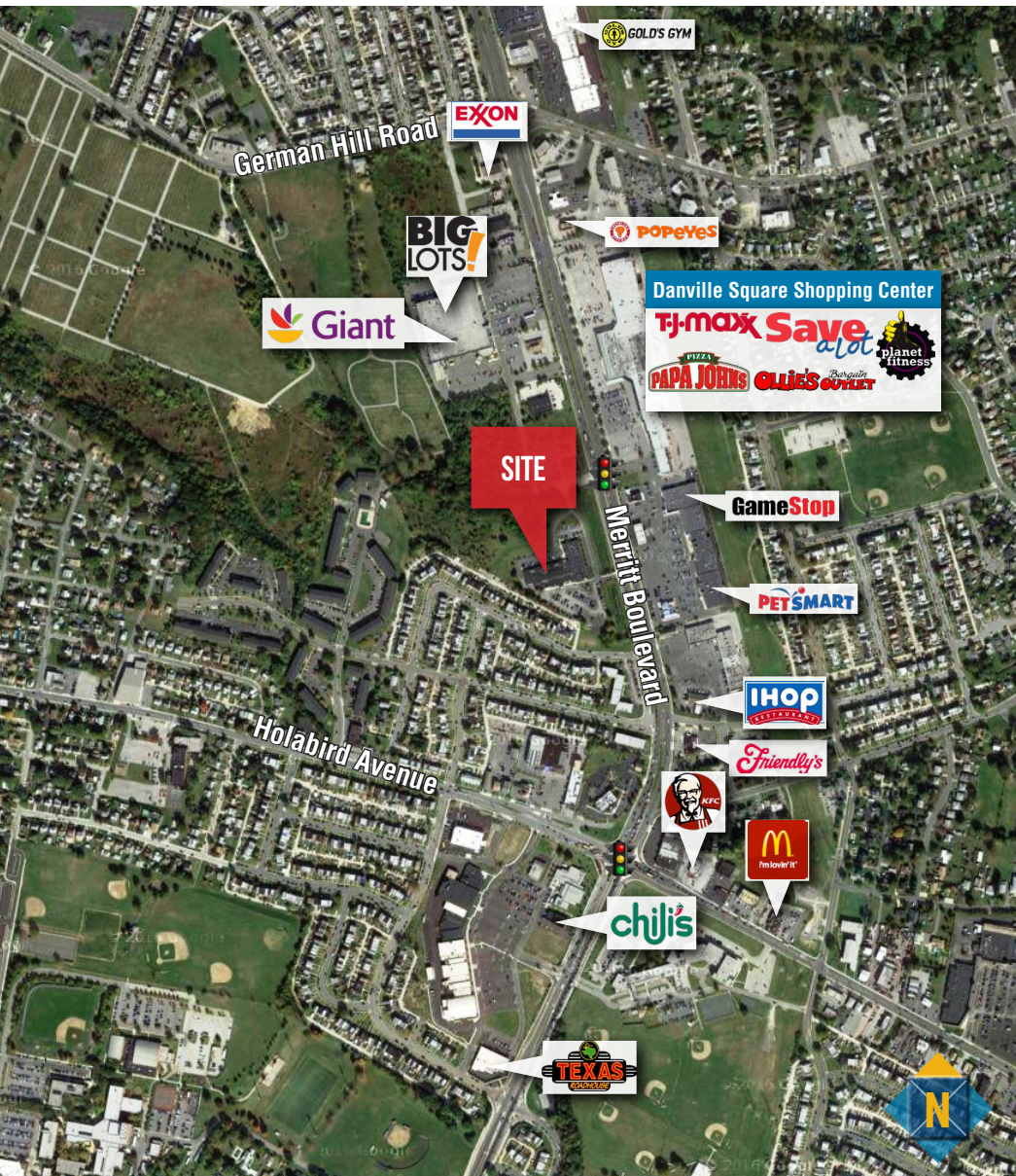

# FOR LEASE

Baltimore County, MD

## SUITE 10:

DUNDALK PROFESSIONAL CENTER | 1576 MERRITT BOULEVARD | BALTIMORE, MARYLAND 21222

### SUITE 10: 1,086 SF

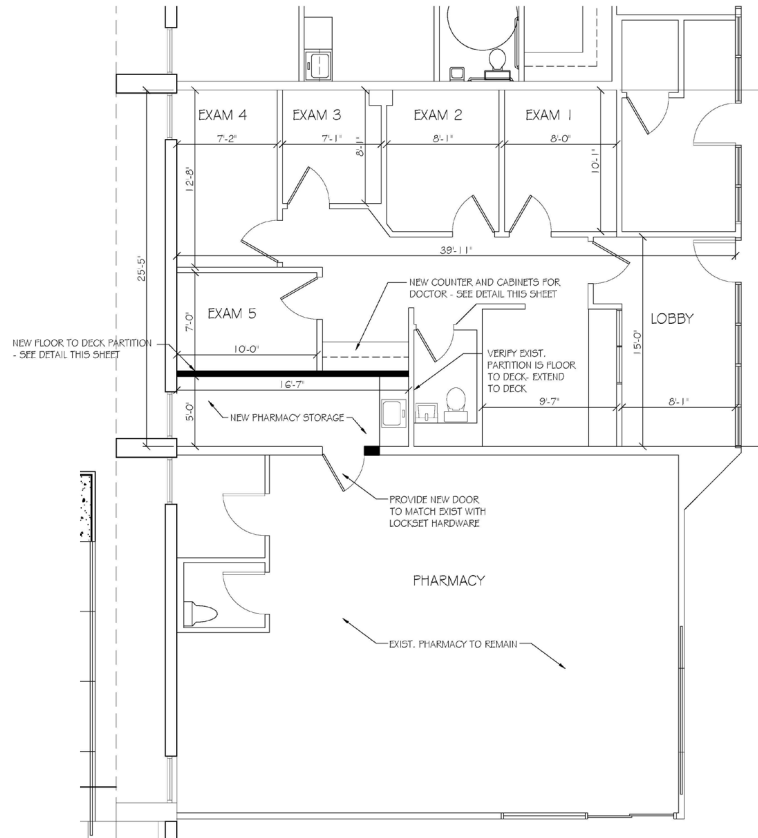

**NEW WORK FLOOR PLAN**  
SCALE: 1/4" = 1'-0"

NEW FLOOR PLAN NOTES:  
1. PREP ALL FLOORING, WALLS, ETC. FOR NEW FINISHES



# FOR LEASE

Baltimore County, MD

# SITE PLAN: PROPOSED ADDITION

DUNDALK PROFESSIONAL CENTER | 1576 MERRITT BOULEVARD | BALTIMORE, MARYLAND 21222



**Joe Bradley**

410.494.4892

jbradley@mackenziecommercial.com

**Matt Mueller**

410.494.6658

mmueller@mackenziecommercial.com

**Henson Ford**

410.494.6657

hford@mackenziecommercial.com

**Dylan Bozel**

410.494.4896

dbozel@mackenziecommercial.com